



**(VARIOUS STREETS, TILlicOUNTRY)
(20 MPH ZONE) ORDER 2014**

Clackmannanshire Council, in exercise of the powers conferred upon it by Section 84(1) and (2) and Part IV of Schedule 9 to the Road Traffic Regulation Act 1984 (as amended) and all other enabling powers and after consultation with the Chief Officer of Police in accordance with Part III of Schedule 9 to the said Act, hereby make the following Order:-

- (1) This Order may be cited as "The Clackmannanshire Council (Various Streets, Tillicoultry) (20 mph Zone) Order 2014" and shall come into operation on the 21 March 2014.
- (2) This Order revokes the following orders:
"The Clackmannanshire Council (Spinners Wynd, Tillicoultry) (20 MPH Zone) Order 2007";
"The Clackmannanshire Council (Various Streets, Tillicoultry) (20 MPH Zone) Order 2008"; and
"The Clackmannanshire Council (Various Streets, Tillicoultry) (20 MPH Zone) (Amendment No. 1) Order 2009".
- (3) The Interpretation Act 1978 shall apply for the interpretation of this Order as it applies for the interpretation of an Act of Parliament.
- (4) A speed limit of 20 miles per hour is hereby imposed on the lengths of roads specified in the Schedule to this Order and no person shall drive any motor vehicle at a speed exceeding 20 miles per hour on the said lengths of roads.

- (5) The restriction imposed by this Order shall be in addition to and not in derogation of any restriction or requirement imposed by any regulations made or having effect as if made under the Road Traffic Regulation Act 1984 or by or under any other enactment.

DATED THIS TWELFTH DAY OF MARCH, TWO THOUSAND AND FOURTEEN

Garry Dallas

Director of Services to Communities

Clackmannanshire Council
Greenfield
ALLOA, FK10 2AD

**THE CLACKMANNANSHIRE COUNCIL
(VARIOUS STREETS, TILlicOUNTRY)
(20 MPH ZONE) ORDER 2014**

Schedule

**Lengths of Road in
Tillicoultry**

**Sections of road over which a 20 mph speed limit will be
applicable.**

Adair Place	For its entirety, a distance of 84 metres or thereby
Armour Place	For its entirety, a distance of 149 metres or thereby
Bard's Way	For its entirety, a distance of 748 metres or thereby
Braehead	For its entirety, a distance of 88 metres or thereby
Cairnton Place	For its entirety, a distance of 25 metres or thereby
Chalmers Place	For its entirety, a distance of 42 metres or thereby
Charlotte Place	For its entirety, a distance of 27 metres or thereby
Crofthead	For its entirety, a distance of 57 metres or thereby
Dorothy Terrace	For its entirety, a distance of 105 metres or thereby
Eastertoun	For its entirety, a distance of 110 metres or thereby
Fir Park	For its entirety, a distance of 175 metres or thereby
Frederick Street	For its entirety, a distance of 114metres or thereby
Glassford Square	For its entirety, a distance of 125 metres or thereby
Hamilton Street	For its entirety, a distance of 275 metres or thereby
Hill Street	For its entirety, a distance of 265 metres or thereby
Hillview Terrace	For its entirety, a distance of 135 metres or thereby
Jamieson Gardens	For its entirety, a distance of 430 metres or thereby
North Hill Street	For its entirety, a distance of 118 metres or thereby
Ochil Street	For its entirety, a distance of 286 metres or thereby
Ochilview Road	For its entirety, a distance of 120 metres or thereby
Primrose Place	For its entirety, a distance of 45 metres or thereby
Provost Jones Court	For its entirety, a distance of 35 metres or thereby
Ramsay Terrace	For its entirety, a distance of 145 metres or thereby
Roundelwood	For its entirety, a distance of 90 metres or thereby
Scotland Place	For its entirety, a distance of 125 metres or thereby
Shillinghill	For its entirety, a distance of 90 metres or thereby
Stalker Avenue	From its junction with Walker Terrace eastwards, for a distance of 405 metres or thereby
Stirling Street	For its entirety, a distance of 286 metres or thereby
Tait Place	For its entirety, a distance of 132 metres or thereby
Union Street	For its entirety, a distance of 214 metres or thereby
Upper Mill Street	For its entirety, a distance of 490 metres or thereby
Walker Terrace	For its entirety, a distance of 298 metres or thereby

**THE CLACKMANNANSHIRE COUNCIL
(VARIOUS STREETS, TILlicOUNTRY)
(20 MPH ZONE) ORDER 2014**

Statement of Reasons for Making the Order

The order is required to ensure that the traffic speeds are limited to a speed compatible with the local environment.

Garry Dallas

Director of Services to Communities

Clackmannanshire Council
Greenfield
ALLOA
FK10 2AD

**THE CLACKMANNANSHIRE COUNCIL
(VARIOUS STREETS, TILlicOUNTRY)
(20 MPH ZONE) ORDER 2014**

Clackmannanshire Council has made the above named Order under Section 84(1) and (2) and Part IV of Schedule 9 to the Road Traffic Regulation Act 1984 (as amended) on 12 March 2014.

FULL DETAILS of this Order is as published in the Alloa Advertiser on the 15 January 2014 and will designate the sections of roads described in the Schedule as a 20 miles per hour zone to ensure that traffic speeds are limited to a speed compatible with the local environment. A copy of the order, together with a copy of the relative plan is available on www.clacksweb.org.uk or may be examined at Clackmannanshire Council's Headquarters at Greenfield, Alloa, FK10 2AD or Lime Tree House, Castle Street, Alloa, FK10 1EX or at any Council Library / CAP, during normal office hours, free of charge.

Any person wishing to object to the validity of the order or of any provision contained therein on the grounds that it is not within the powers conferred by the aforesaid Act or that if any requirement therein has not been complied with, may within six weeks from 21 March 2014 apply to the Court of Session for this purpose.

Garry Dallas

Director of Services to Communities

Clackmannanshire Council, Greenfield, ALLOA, FK10 2AD

Schedule

**Lengths of Road in
Tillicoultry**

**Sections of road over which a 20 mph speed limit will be
applicable.**

Adair Place	For its entirety, a distance of 84 metres or thereby
Armour Place	For its entirety, a distance of 149 metres or thereby
Bard's Way	For its entirety, a distance of 748 metres or thereby
Braehead	For its entirety, a distance of 88 metres or thereby
Cairnton Place	For its entirety, a distance of 25 metres or thereby
Chalmers Place	For its entirety, a distance of 42 metres or thereby
Charlotte Place	For its entirety, a distance of 27 metres or thereby
Crothead	For its entirety, a distance of 57 metres or thereby
Dorothy Terrace	For its entirety, a distance of 105 metres or thereby
Eastertoun	For its entirety, a distance of 110 metres or thereby

Fir Park	For its entirety, a distance of 175 metres or thereby
Frederick Street	For its entirety, a distance of 114metres or thereby
Glassford Square	For its entirety, a distance of 125 metres or thereby
Hamilton Street	For its entirety, a distance of 275 metres or thereby
Hill Street	For its entirety, a distance of 265 metres or thereby
Hillview Terrace	For its entirety, a distance of 135 metres or thereby
Jamieson Gardens	For its entirety, a distance of 430 metres or thereby
North Hill Street	For its entirety, a distance of 118 metres or thereby
Ochil Street	For its entirety, a distance of 286 metres or thereby
Ochilview Road	For its entirety, a distance of 120 metres or thereby
Primrose Place	For its entirety, a distance of 45 metres or thereby
Provost Jones Court	For its entirety, a distance of 35 metres or thereby
Ramsay Terrace	For its entirety, a distance of 145 metres or thereby
Roundelwood	For its entirety, a distance of 90 metres or thereby
Scotland Place	For its entirety, a distance of 125 metres or thereby
Shillinghill	For its entirety, a distance of 90 metres or thereby
Stalker Avenue	From its junction with Walker Terrace eastwards, for a distance of 405 metres or thereby
Stirling Street	For its entirety, a distance of 286 metres or thereby
Tait Place	For its entirety, a distance of 132 metres or thereby
Union Street	For its entirety, a distance of 214 metres or thereby
Upper Mill Street	For its entirety, a distance of 490 metres or thereby
Walker Terrace	For its entirety, a distance of 298 metres or thereby

**THE CLACKMANNANSHIRE COUNCIL
(VARIOUS STREETS, TILlicOUNTRY)
(20 MPH ZONE) ORDER 2014**

This is the plan referred to in The Clackmannanshire Council (Various Streets, Tillicoultry) (20 MPH Zone) Order 2014 made by Clackmannanshire Council on 12 March 2014.

Garry Dallas

Director of Services to Communities

Clackmannanshire Council
Greenfield
ALLOA
FK10 2AD

THE CLACKMANNANSHIRE COUNCIL (VARIOUS STREETS, TILlicOUNTRY) (20 MPH ZONE) ORDER 2014

The Council proposes to make the above Order under Section 84(1) and (2) and Part IV of Schedule 9 to the Road Traffic Regulation Act 1984. This will designate the sections of roads in Tillicoultry: Adair Place, Armour Place, Bard's Way, Braehead, Cairnton Place, Chalmers Place, Charlotte Place, Crofthead, Dorothy Terrace, Easterton, Frederick Street, Glassford Square, Hamilton Street, Hill Street, Hillview Terrace, Jamieson Gardens, North Hill Street, Ochil Street, Ochilview Road, Primrose Place, Provost Jones Court, Ramsay Terrace, Roundelwood, Scotland Place, Shillinghill, Stirling Street, Tait Place, Union Street, Upper Mill Street, and Walker Terrace for their entirety; Fir Park (From its junction with Stalker Avenue, northwards for a distance of 175 metres or thereby); and Stalker Avenue (From its junction with Walker Terrace eastwards for a distance of 405 metres or thereby) as a 20 miles per hour zone to ensure that traffic speeds are limited to a speed compatible with the local environment. Objectors must state their reasons in writing to Gillian White, Strategy and Customer Services, Greenfield, Alloa, FK10 2AD by 07/02/14. Full details are available on www.clacksweb.org.uk or may be examined at Clackmannanshire Council's Offices, Greenfield, Alloa, FK10 2AD, and any Council Office/Library, during normal office hours between 15/01/14 and 07/02/14.

THE CLACKMANNANSHIRE COUNCIL (VARIOUS STREETS, TILlicOUNTRY) (20 MPH ZONE) ORDER 2014

The Council has made the above Order under Section 84(1) and (2) and Part IV of Schedule 9 to the Road Traffic Regulation Act 1984. This will designate the sections of roads in Tillicoultry: Adair Place, Armour Place, Bard's Way, Braehead, Cairnton Place, Chalmers Place, Charlotte Place, Crofthead, Dorothy Terrace, Easterton, Frederick Street, Glassford Square, Hamilton Street, Hill Street, Hillview Terrace, Jamieson Gardens, North Hill Street, Ochil Street, Ochilview Road, Primrose Place, Provost Jones Court, Ramsay Terrace, Roundelwood, Scotland Place, Shillinghill, Stirling Street, Tait Place, Union Street, Upper Mill Street, and Walker Terrace for their entirety; Fir Park (From its junction with Stalker Avenue, northwards for a distance of 175 metres or thereby); and Stalker Avenue (From its junction with Walker Terrace eastwards for a distance of 405 metres or thereby) as a 20 miles per hour zone to ensure that traffic speeds are limited to a speed compatible with the local environment. Anyone wishing to question the validity of any of the provisions within this order should write to the Court of session within six weeks of 21 March 2014. Full details are available on www.clacksweb.org.uk or may be examined at Clackmannanshire Council's Offices, Greenfield, Alloa, FK10 2AD, and any Council Office/Library, during normal office hours.

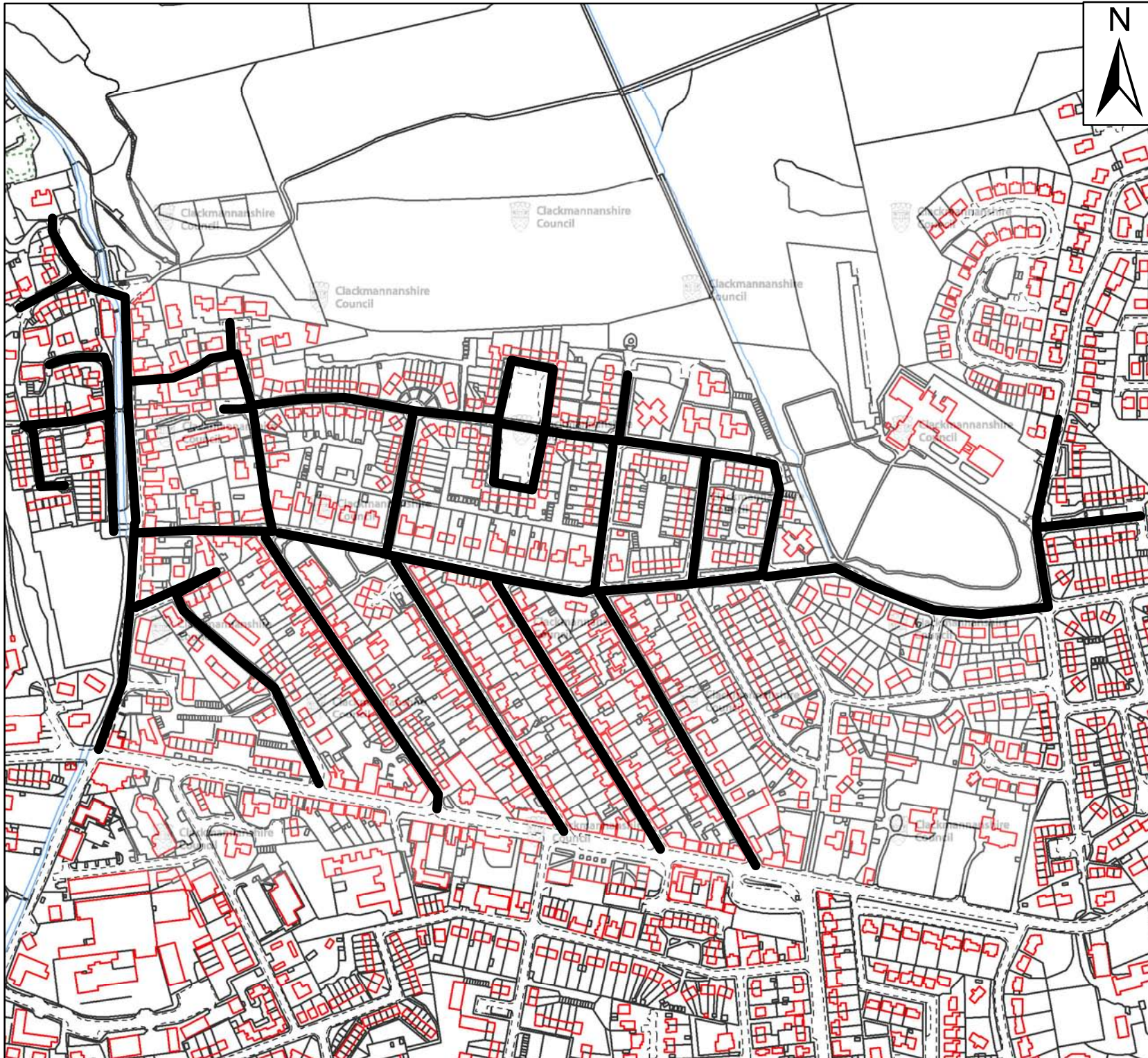

 20mph Zone

DRG13-112A
Tillicoultry
20mph Zone

Scale : NTS
Paper Size : A4

Date : September 2013

 **Clackmannanshire Council**
www.clacksweb.org.uk
Services to Communities
Kilncraigs
Greenside Street
Alloa
FK10 1EB

Tel: 01259 450 000 Fax: 01259 727 452
development_services@clacks.gov.uk

Reproduced by permission of Ordnance Survey on behalf of HMSO. © Crown copyright and database right 2013. All rights reserved.
Ordnance Survey Licence number 100020783.

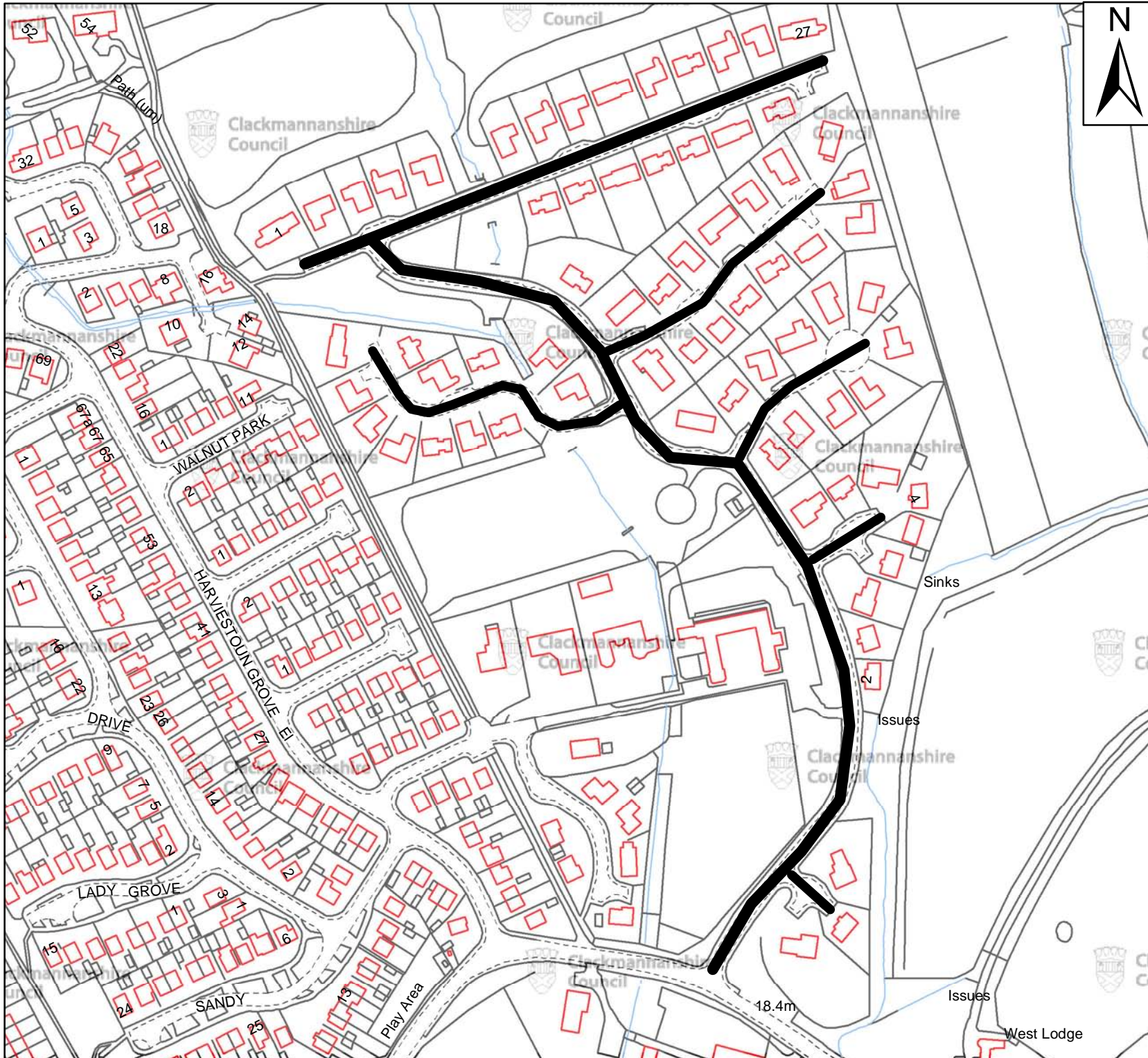

20mph Zone

DRG13-112
Various Street, Tillicoultry

Scale : NTS
 Paper Size : A4

Date : September 2013

 **Clackmannanshire Council**
www.clacksweb.org.uk
 Services to Communities
 Kilncraigs
 Greenside Street
 Alloa
 FK10 1EB

Tel: 01259 450 000 Fax: 01259 727 452
development_services@clacks.gov.uk

Reproduced by permission of Ordnance Survey on behalf of HMSO. © Crown copyright and database right 2013. All rights reserved.
 Ordnance Survey Licence number 100020783.