



**(VARIOUS STREETS, DEVONSIDE - TILlicOUNTRY)
(20 MPH SPEED LIMIT) ORDER 2014**

Clackmannanshire Council, in exercise of the powers conferred upon it by Section 84(1) and (2) and Part IV of Schedule 9 to the Road Traffic Regulation Act 1984 (as amended) and all other enabling powers and after consultation with the Chief Officer of Police in accordance with Part III of Schedule 9 to the said Act, hereby make the following Order:-

- (1) This Order may be cited as "The Clackmannanshire Council (Various Streets, Devonside - Tillicoultry) (20 mph Speed Limit) Order 2014" and shall come into operation on the 24 January 2014.
- (2) The Interpretation Act 1978 shall apply for the interpretation of this Order as it applies for the interpretation of an Act of Parliament.
- (3) A speed limit of 20 miles per hour is hereby imposed on the lengths of roads specified in the Schedule to this Order and no person shall drive any motor vehicle at a speed exceeding 20 miles per hour on the said lengths of roads.
- (4) The restriction imposed by this Order shall be in addition to and not in derogation of any restriction or requirement imposed by any regulations made or having effect as if made under the Road Traffic Regulation Act 1984 or by or under any other enactment.

DATED THIS NINTH DAY OF JANUARY, TWO THOUSAND AND FOURTEEN

Garry Dallas

Director of Services to Communities

**THE CLACKMANNANSHIRE COUNCIL
(VARIOUS STREETS, DEVONSIDE - TILlicOUNTRY)
(20 MPH SPEED LIMIT) ORDER 2014**

Schedule

**Lengths of Road in
Devonside - Tillicoultry**

**Sections of road over which a 20 mph speed limit will be
applicable.**

Bain Street

For its entirety, a distance of 75 metres or thereby

Drummie Road

For its entirety, a distance of 185 metres or thereby

Ochil View

For its entirety, a distance of 185 metres or thereby

The Craigs

For its entirety, a distance of 125 metres or thereby

**THE CLACKMANNANSHIRE COUNCIL
(VARIOUS STREETS, DEVONSIDE - TILlicOUNTRY)
(20 MPH SPEED LIMIT) ORDER 2014**

Statement of Reasons for Making the Order

The order is required to ensure that the traffic speeds are limited to a speed compatible with the local environment.

Garry Dallas
Director of Services to Communities

Clackmannanshire Council
Greenfield
ALLOA
FK10 2AD

**THE CLACKMANNANSHIRE COUNCIL
(VARIOUS STREETS, DEVONSIDE - TILlicOUNTRY)
(20 MPH SPEED LIMIT) ORDER 2014**

Clackmannanshire Council has made the above named Order under Section 84(1) and (2) and Part IV of Schedule 9 to the Road Traffic Regulation Act 1984 (as amended) on 9 January 2014.

FULL DETAILS of this Order is as published in the Alloa Advertiser on the 20 November 2014 and will designate the sections of roads described in the Schedule as a 20 miles per hour speed limit to ensure that traffic speeds are limited to a speed compatible with the local environment. A copy of the order, together with a copy of the relative plan is available on www.clacksweb.org.uk or may be examined at Clackmannanshire Council's Headquarters at Greenfield, Alloa, FK10 2AD or Lime Tree House, Castle Street, Alloa, FK10 1EX or at any Council Library / CAP, during normal office hours, free of charge.

Any person wishing to object to the validity of the order or of any provision contained therein on the grounds that it is not within the powers conferred by the aforesaid Act or that if any requirement therein has not been compiled with, may within six weeks from 24 January 2014 apply to the Court of Session for this purpose.

Garry Dallas

Director of Services to Communities

Clackmannanshire Council, Greenfield, ALLOA, FK10 2AD

Schedule

**Lengths of Road in
Devonside - Tillicoultry**

**Sections of road over which a 20 mph speed limit will be
applicable.**

Bain Street

For its entirety, a distance of 75 metres or thereby

Drummie Road

For its entirety, a distance of 185 metres or thereby

Ochil View

For its entirety, a distance of 185 metres or thereby

The Craigs

For its entirety, a distance of 125 metres or thereby

**THE CLACKMANNANSHIRE COUNCIL
(VARIOUS STREETS, DEVONSIDE - TILlicOUNTRY)
(20 MPH SPEED LIMIT) ORDER 2014**

This is the plan referred to in The Clackmannanshire Council (Various Streets, Devonside - Tillicoultry) (20 mph Speed Limit) Order 2014 made by Clackmannanshire Council on 9 January 2014.

Garry Dallas
Director of Services to Communities

Clackmannanshire Council
Greenfield
ALLOA
FK10 2AD

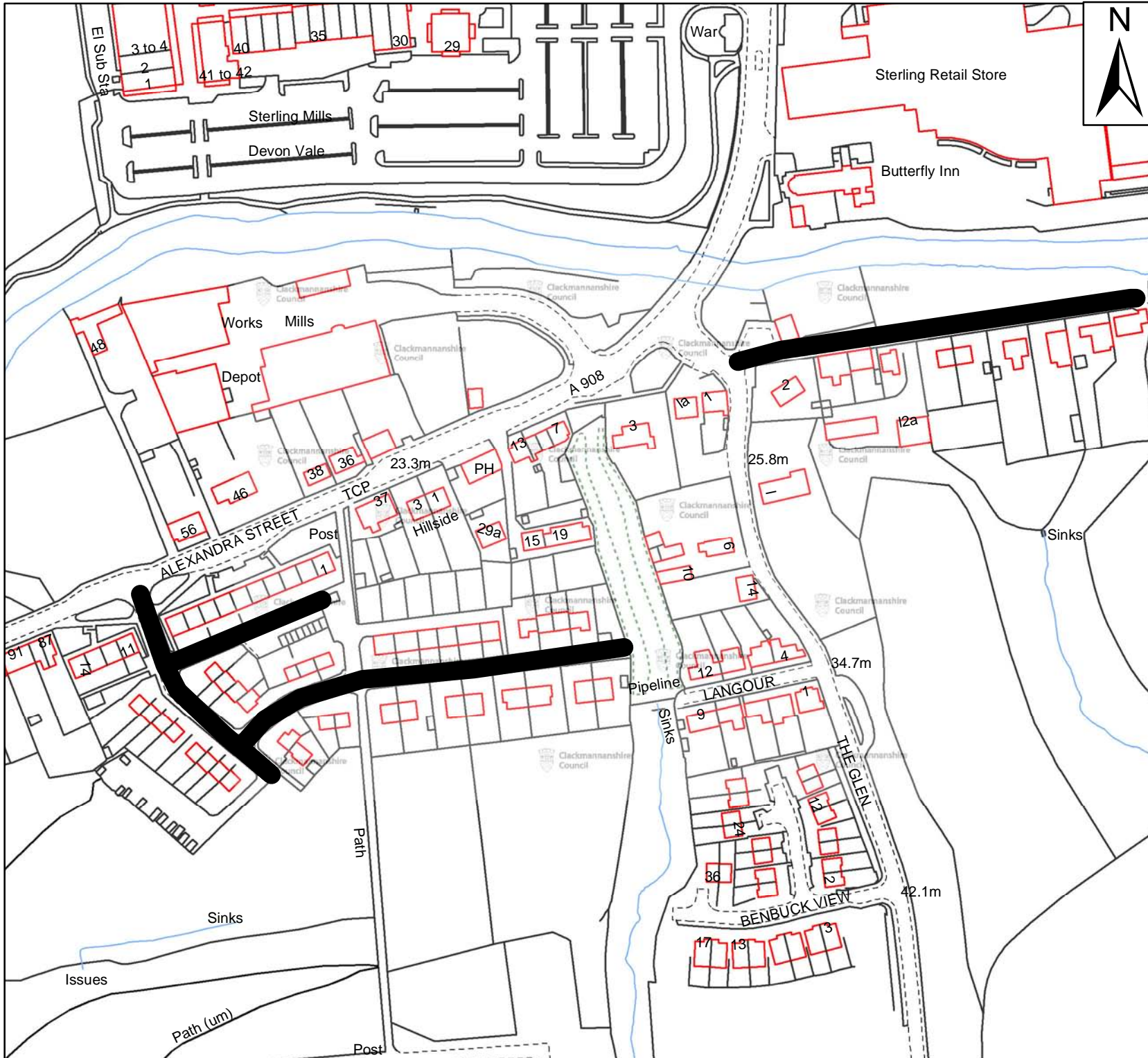

20mph Speed Limit

DRG13-107
 Devonside, Tillicoultry
 20mph Speed Limit

Scale : NTS
 Paper Size : A4

Date : August 2013

 **Clackmannanshire Council**
www.clacksweb.org.uk
 Services to Communities
 Kilncraigs
 Greenside Street
 Alloa
 FK10 1EB

Tel: 01259 450 000 Fax: 01259 727 452
 development_services@clacks.gov.uk

Reproduced by permission of Ordnance Survey on behalf of HMSO. © Crown copyright and database right 2013. All rights reserved.
 Ordnance Survey Licence number 100020783.