



**Clackmannanshire  
Council**

[www.clacksweb.org.uk](http://www.clacksweb.org.uk)

**(VARIOUS STREETS, SAUCHIE)  
(20 MPH SPEED LIMIT) ORDER 2014**

Clackmannanshire Council, in exercise of the powers conferred upon it by Section 84(1) and (2) and Part IV of Schedule 9 to the Road Traffic Regulation Act 1984 (as amended) and all other enabling powers and after consultation with the Chief Officer of Police in accordance with Part III of Schedule 9 to the said Act, hereby make the following Order:-

- (1) This Order may be cited as "The Clackmannanshire Council (Various Streets, Sauchie) (20 mph Speed Limit) Order 2014" and shall come into operation on the 24 January 2014.
- (2) The Interpretation Act 1978 shall apply for the interpretation of this Order as it applies for the interpretation of an Act of Parliament.
- (3) A speed limit of 20 miles per hour is hereby imposed on the lengths of roads specified in the Schedule to this Order and no person shall drive any motor vehicle at a speed exceeding 20 miles per hour on the said lengths of roads.
- (4) The restriction imposed by this Order shall be in addition to and not in derogation of any restriction or requirement imposed by any regulations made or having effect as if made under the Road Traffic Regulation Act 1984 or by or under any other enactment.

**DATED THIS NINTH DAY OF JANUARY, TWO THOUSAND AND FOURTEEN**

**Garry Dallas**

Director of Services to Communities

Clackmannanshire Council  
Greenfield  
ALLOA, FK10 2AD

**THE CLACKMANNANSHIRE COUNCIL  
(VARIOUS STREETS, SAUCHIE)  
(20 MPH SPEED LIMIT) ORDER 2014**

**Schedule**

<b>Lengths of Road in Sauchie</b>	<b>Sections of road over which a 20 mph speed limit will be applicable.</b>
Abbeycraig Road	For its entirety, a distance of 322 metres or thereby
Arnswell	For its entirety, a distance of 105 metres or thereby
Auchinbaird	For its entirety, a distance of 430 metres or thereby
Birchwood	For its entirety, a distance of 65 metres or thereby
Blairdenon Drive	For its entirety, a distance of 225 metres or thereby
Branshill Park	For its entirety, a distance of 836 metres or thereby
Branshill Road	From its junction with Roundelwood, southwards for a distance of 172 metres or thereby.
Church Grove	For its entirety, a distance of 285 metres or thereby
Craigbank	For its entirety, a distance of 320 metres or thereby
Craigview	For its entirety, a distance of 450 metres or thereby
Crophill	For its entirety, a distance of 140 metres or thereby
Diverswell	For its entirety, a distance of 110 metres or thereby
Fairmount Drive	For its entirety, a distance of 415 metres or thereby
Greygoran	For its entirety, a distance of 520 metres or thereby
Hillside	For its entirety, a distance of 250 metres or thereby
Lochbrae	For its entirety, a distance of 210 metres or thereby
Main Street Access Road	For its entirety, a distance of 110 metres or thereby
Meadowgreen	For its entirety, a distance of 170 metres or thereby
Millars Wynd	For its entirety, a distance of 145 metres or thereby
Newtonshaw	For its entirety, a distance of 245 metres or thereby
Pompee Road	For its entirety, a distance of 555 metres or thereby
Roundelwood	For its entirety, a distance of 250 metres or thereby
Swinburne Drive	For its entirety, a distance of 250 metres or thereby
Ten Acres	For its entirety, a distance of 565 metres or thereby
The Hennings	For its entirety, a distance of 440 metres or thereby
The Knowe	For its entirety, a distance of 120 metres or thereby
The Rowans	For its entirety, a distance of 70 metres or thereby
Woodlea Gardens	For its entirety, a distance of 175 metres or thereby
Woodlea Park	For its entirety, a distance of 540 metres or thereby

**THE CLACKMANNANSHIRE COUNCIL  
(VARIOUS STREETS, SAUCHIE)  
(20 MPH SPEED LIMIT) ORDER 2014**

**Statement of Reasons for Making the Order**

The order is required to ensure that the traffic speeds are limited to a speed compatible with the local environment.

**Garry Dallas**  
Director of Services to Communities

Clackmannanshire Council  
Greenfield  
ALLOA  
FK10 2AD

**THE CLACKMANNANSHIRE COUNCIL  
(VARIOUS STREETS, SAUCHIE)  
(20 MPH SPEED LIMIT) ORDER 2014**

Clackmannanshire Council has made the above named Order under Section 84(1) and (2) and Part IV of Schedule 9 to the Road Traffic Regulation Act 1984 (as amended) on 9 January 2014.

FULL DETAILS of this Order is as published in the Alloa Advertiser on the 20 November 2013 and will designate the sections of roads described in the Schedule as a 20 miles per hour speed limit to ensure that traffic speeds are limited to a speed compatible with the local environment. A copy of the order, together with a copy of the relative plan is available on [www.clacksweb.org.uk](http://www.clacksweb.org.uk) or may be examined at Clackmannanshire Council's Headquarters at Greenfield, Alloa, FK10 2AD or Lime Tree House, Castle Street, Alloa, FK10 1EX or at any Council Library / CAP, during normal office hours, free of charge.

Any person wishing to object to the validity of the order or of any provision contained therein on the grounds that it is not within the powers conferred by the aforesaid Act or that if any requirement therein has not been compiled with, may within six weeks from 24 January 2014 apply to the Court of Session for this purpose.

**Garry Dallas**

Director of Services to Communities

Clackmannanshire Council, Greenfield, ALLOA, FK10 2AD

**Schedule**

<b>Lengths of Road in Sauchie</b>	<b>Sections of road over which a 20 mph speed limit will be applicable.</b>
Abbeycraig Road	For its entirety, a distance of 322 metres or thereby
Arnswell	For its entirety, a distance of 105 metres or thereby
Auchinbaird	For its entirety, a distance of 430 metres or thereby
Birchwood	For its entirety, a distance of 65 metres or thereby
Blairdenon Drive	For its entirety, a distance of 225 metres or thereby
Branshill Park	For its entirety, a distance of 836 metres or thereby
Branshill Road	From its junction with Roundelwood, southwards for a distance of 172 metres or thereby.
Church Grove	For its entirety, a distance of 285 metres or thereby
Craigbank	For its entirety, a distance of 320 metres or thereby
Craigview	For its entirety, a distance of 450 metres or thereby

Crophill	For its entirety, a distance of 140 metres or thereby
Diverswell	For its entirety, a distance of 110 metres or thereby
Fairmount Drive	For its entirety, a distance of 415 metres or thereby
Greygoran	For its entirety, a distance of 520 metres or thereby
Hillside	For its entirety, a distance of 250 metres or thereby
Lochbrae	For its entirety, a distance of 210 metres or thereby
Main Street Access Road	For its entirety, a distance of 110 metres or thereby
Meadowgreen	For its entirety, a distance of 170 metres or thereby
Millars Wynd	For its entirety, a distance of 145 metres or thereby
Newtonshaw	For its entirety, a distance of 245 metres or thereby
Pompee Road	For its entirety, a distance of 555 metres or thereby
Roundelwood	For its entirety, a distance of 250 metres or thereby
Swinburne Drive	For its entirety, a distance of 250 metres or thereby
Ten Acres	For its entirety, a distance of 565 metres or thereby
The Hennings	For its entirety, a distance of 440 metres or thereby
The Knowe	For its entirety, a distance of 120 metres or thereby
The Rowans	For its entirety, a distance of 70 metres or thereby
Woodlea Gardens	For its entirety, a distance of 175 metres or thereby
Woodlea Park	For its entirety, a distance of 540 metres or thereby

**THE CLACKMANNANSHIRE COUNCIL  
(VARIOUS STREETS, SAUCHIE)  
(20 MPH SPEED LIMIT) ORDER 2014**

This is the plan referred to in The Clackmannanshire Council (Various Streets, Sauchie) (20 mph Speed Limit) Order 2014 made by Clackmannanshire Council on 9 January 2014.

**Garry Dallas**  
Director of Services to Communities

Clackmannanshire Council  
Greenfield  
ALLOA  
FK10 2AD

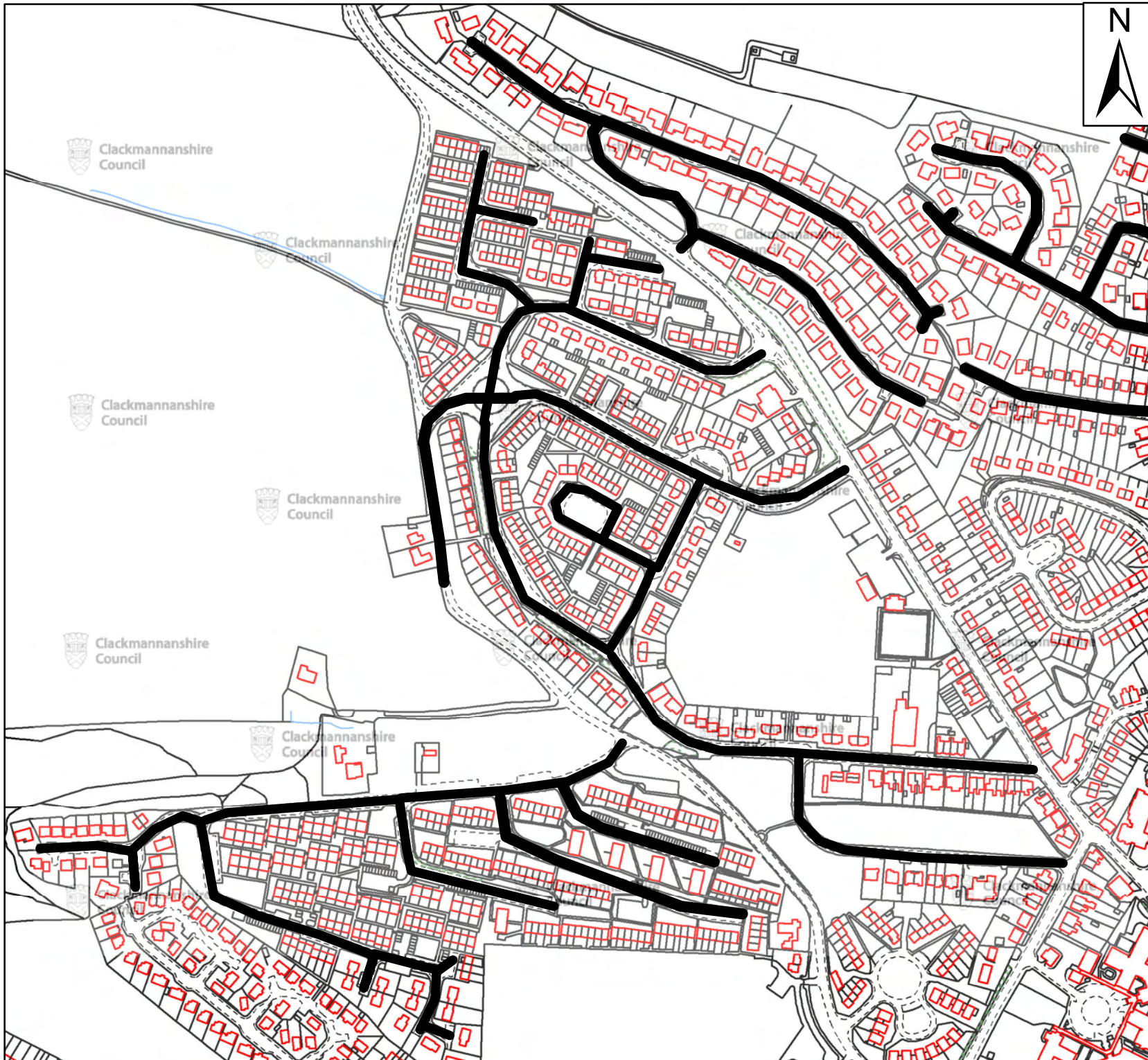

 N

 20mph Speed Limit

DRG13-096  
Sauchie  
20mph Speed Limit

Scale : NTS  
Paper Size : A4

Date : August 2013

 **Clackmannanshire Council**  
[www.clacksweb.org.uk](http://www.clacksweb.org.uk)  
Services to Communities  
Kilncraigs  
Greenside Street  
Alloa  
FK10 1EB

Tel: 01259 450 000 Fax: 01259 727 452  
[development\\_services@clacks.gov.uk](mailto:development_services@clacks.gov.uk)

Reproduced by permission of Ordnance Survey on behalf of HMSO. © Crown copyright and database right 2013. All rights reserved.  
Ordnance Survey Licence number 100020783.