



**(TULLIBODY)
(TEMPORARY CLOSURES) ORDER 2016**

The Clackmannanshire Council, in exercise of the powers conferred on them by Section 14 of the Road Traffic Regulation Act 1984 as amended by the Road Traffic (Temporary Restrictions) Act 1991 and of all other powers enabling them in that behalf, hereby make the following Order.

1. This Order may be cited as "The Clackmannanshire Council (Tullibody) (Temporary Closures) Order 2016" and notwithstanding the date hereof shall come into operation on the 2nd March 2016.
2. The effect of this Order shall be to close to pedestrians at Delph Pond Footpaths:-
The period from 0800 hours on Monday 14th March 2016 for a period of 5 weeks or until completion on the section described in Schedule 1 attached.
3. The effect of this Order shall be to close to pedestrians at Alloa Road, Tullibody : -
The period from 0800 hours on Monday 4th April 2016 for a period of 6 weeks or until completion on the section described in Schedule 2 attached.
4. The effect of this Order shall be to close to pedestrians at footpath leading to Westview Crescent: -
The period from 0800 hours on Monday 11th April 2016 for a period of 4 weeks or until completion on the section described in Schedule 3 attached.
5. The effect of this Order shall be to close to pedestrians at Footway from Lornshill Academy to Alloa Road (side road): - The period from 0800 hours on Wednesday 29th June 2016 for a period of 7 weeks or until completion on the section described in Schedule 4 attached.

The temporary closures are necessary for footway/footpath upgrades.

DATED THIS THIRD DAY OF MARCH, TWO THOUSAND AND SIXTEEN

Garry Dallas
Executive Director

Clackmannanshire Council, Kilncraigs, ALLOA, FK10 1EB

SCHEDULE 1	
List of Footpath	Section of road over which a temporary footpath closure will be applicable from 0800 hours on Monday 14th March 2016 for a period of 5 weeks or until completion.

Delph Pond Footpaths	From its joining point with Delph Wynd to its joining point with Delph Road, a total of 390 metres or thereby.
Diversion	Via south footpath linking Delph Road to Delph Wynd.
SCHEDULE 2	
List of Footway	Section of road over which a footway closure will be applicable from 0800 hours on Monday 4th April 2016 for a period of 6 weeks or until completion.
Alloa Road, Tullibody	Northside From its junction with Muirside Road to its junction with Blackmuir Place, a distance of 90 metres or thereby.
Diversion	Via southside footway.
SCHEDULE 3	
List of Footpath	Section of road over which a footpath closure will be applicable from 0800 hours on Monday 11th April 2016 for a period of 4 weeks.
Footpath leading to Westview Crescent	From its junction with Alloa Road, Tullibody southwards to its junction with Westview Crescent, a distance of 95 metres or thereby.
Diversion	Via Westview Crescent, Firs Road, Alloa Road and vice versa.
SCHEDULE 4	
List of Footway	Section of road over which a footway closure will be applicable from 0800 hours on Wednesday 29th June 2016 for a period of 7 weeks or until completion.
Footway from Lornshill Academy to Alloa Road (side road)	Northside From its junction with Lornshill Academy westbound to its joining point with Alloa Road (side road), a distance of 470 metres or thereby.
Diversion	Via southside footway.

THE CLACKMANNANSHIRE COUNCIL
(TULLIBODY)
(TEMPORARY CLOSURES) ORDER 2016

STATEMENT OF REASONS FOR MAKING THE ORDER

The order is necessary for footway/footpath upgrades.

Garry Dallas
Executive Director

Clackmannanshire Council
Kilncraigs
ALLOA
FK10 1EB

The Clackmannanshire Council (Tullibody) (Temporary Closures) Order 2016

The Council has made "The Clackmannanshire Council (Tullibody) (Temporary Closures) Order 2016", under the Road Traffic Regulation Act 1984 (as amended) on 3rd March 2016 as follows: **Schedule 1:** to close to pedestrians the section of footpath at **Delph Pond Footpaths** from its joining point with Delph Wynd to its joining point with Delph Road, a total distance of 390 metres or thereby. (Diversion: Via south footpath linking Delph Road to Delph Wynd). The order runs from 0800 hours on Monday 14th March 2016 for a period of 5 weeks or until completion (Temporary Footpath Closure). **Schedule 2:** to close to pedestrians the section of footway at **Alloa Road, Tullibody (Northside)** from its junction with Muirside Road to its junction with Blackmuir Place, a distance of 90 metres or thereby. (Diversion: Via southside footway). The order runs from 0800 hours on Monday 4th April 2016 for a period of 6 weeks or until completion (Temporary Footway Closure). **Schedule 3:** to close to pedestrians the section of footpath at **Footpath leading to Westview Crescent** from its junction with Alloa Road, Tullibody southwards to its junction with Westview Crescent, a distance of 95 metres or thereby. (Diversion: Via Westview Crescent, Firs Road, Alloa Road and vice versa). The order runs from 0800 hours on Monday 11th April 2016 for a period of 4 weeks or until completion (Temporary Footpath Closure). **Schedule 4:** to close to pedestrians the section of footway at **Footway from Lornshill Academy to Alloa Road (side road) (Northside)** from its junction with Lornshill Academy westbound to its joining point with Alloa Road (side road), a distance of 470 metres or thereby. (Diversion: Via southside footway). The order runs from 0800 hours on Wednesday 29th June 2016 for a period of 7 weeks or until completion. (Temporary Footway Closure). The closures are necessary for footway/footpath upgrades. Full details are available on www.clacksweb.org.uk or may be examined at Clackmannanshire Council's Offices, Kilncraigs, Alloa, FK10 1EB, and any Council Office/Library, during normal office hours.

THE CLACKMANNANSHIRE COUNCIL
(TULLIBODY)
(TEMPORARY CLOSURES) ORDER 2016

The Clackmannanshire Council has made the above named Order under Section 14 of the Road Traffic Regulation Act 1984 (as amended) on 3rd March 2016.

1. The effect of this Order shall be to close to pedestrians at Delph Pond Footpaths:-
The period from 0800 hours on Monday 14th March 2016 for a period of 5 weeks or until completion on the section described in Schedule 1 attached.

2. The effect of this Order shall be to close to pedestrians at Alloa Road, Tullibody: -
The period from 0800 hours on Monday 4th April 2016 for a period of 6 weeks or until completion on the section described in Schedule 2 attached.

3. The effect of this Order shall be to close to pedestrians at the Footpath leading to Westview Crescent: -
The period from 0800 hours on Monday 11th April 2016 for a period of 4 weeks or until completion on the section described in Schedule 3 attached.

4. The effect of this Order shall be to close to pedestrians at Footway from Lornshill Academy to Alloa Road (side road: -
The period from 0800 hours on Wednesday 29th June 2016 for a period of 7 weeks or until completion on the section described in Schedule 4 attached.

The temporary closures are necessary for footway/footpath upgrades.

A copy of the Order, together with a copy of the relative plan, is available on www.clacksweb.org.uk or may be examined at Clackmannanshire Council's Offices, Kilncraigs, Alloa, FK10 1EB, and any Council Office/Library, during normal office hours free of charge.

Garry Dallas
Executive Director

Clackmannanshire Council
Kilncraigs
ALLOA
FK10 1EB

SCHEDULE 1	
List of Footpath	Section of road over which a temporary footpath closure will be applicable from 0800 hours on Monday 14th March 2016 for a period of 5 weeks or until completion.

Delph Pond Footpaths	From its joining point with Delph Wynd to its joining point with Delph Road, a total of 390 metres or thereby.
Diversion	Via south footpath linking Delph Road to Delph Wynd.
SCHEDULE 2	
List of Footway	Section of road over which a footway closure will be applicable from 0800 hours on Monday 4th April 2016 for a period of 6 weeks or until completion.
Alloa Road, Tullibody	Northside From its junction with Muirside Road to its junction with Blackmuir Place, a distance of 90 metres or thereby.
Diversion	Via southside footway.
SCHEDULE 3	
List of Footpath	Section of road over which a footpath closure will be applicable from 0800 hours on Monday 11th April 2016 for a period of 4 weeks.
Footpath leading to Westview Crescent	From its junction with Alloa Road, Tullibody southwards to its junction with Westview Crescent, a distance of 95 metres or thereby.
Diversion	Via Westview Crescent, Firs Road, Alloa Road and vice versa.
SCHEDULE 4	
List of Footway	Section of road over which a footway closure will be applicable from 0800 hours on Wednesday 29th June 2016 for a period of 7 weeks or until completion.
Footway from Lornshill Academy to Alloa Road (side road)	Northside From its junction with Lornshill Academy westbound to its joining point with Alloa Road (side road), a distance of 470 metres or thereby.
Diversion	Via southside footway.

THE CLACKMANNANSHIRE COUNCIL
(TULLIBODY)
(TEMPORARY CLOSURES) ORDER 2016

This is the plan referred to in the Clackmannanshire Council (Tullibody) (Temporary Closures) Order 2016.

Made by Clackmannanshire Council on 3rd March 2016.

Garry Dallas
Executive Director

Clackmannanshire Council
Kilncraigs
ALLOA
FK10 1EB

FP - Schedule 1

-  Closure
-  Diversion

FP - Schedule 2

-  Closure
-  Diversion

FP - Schedule 3

-  Closure
-  Diversion

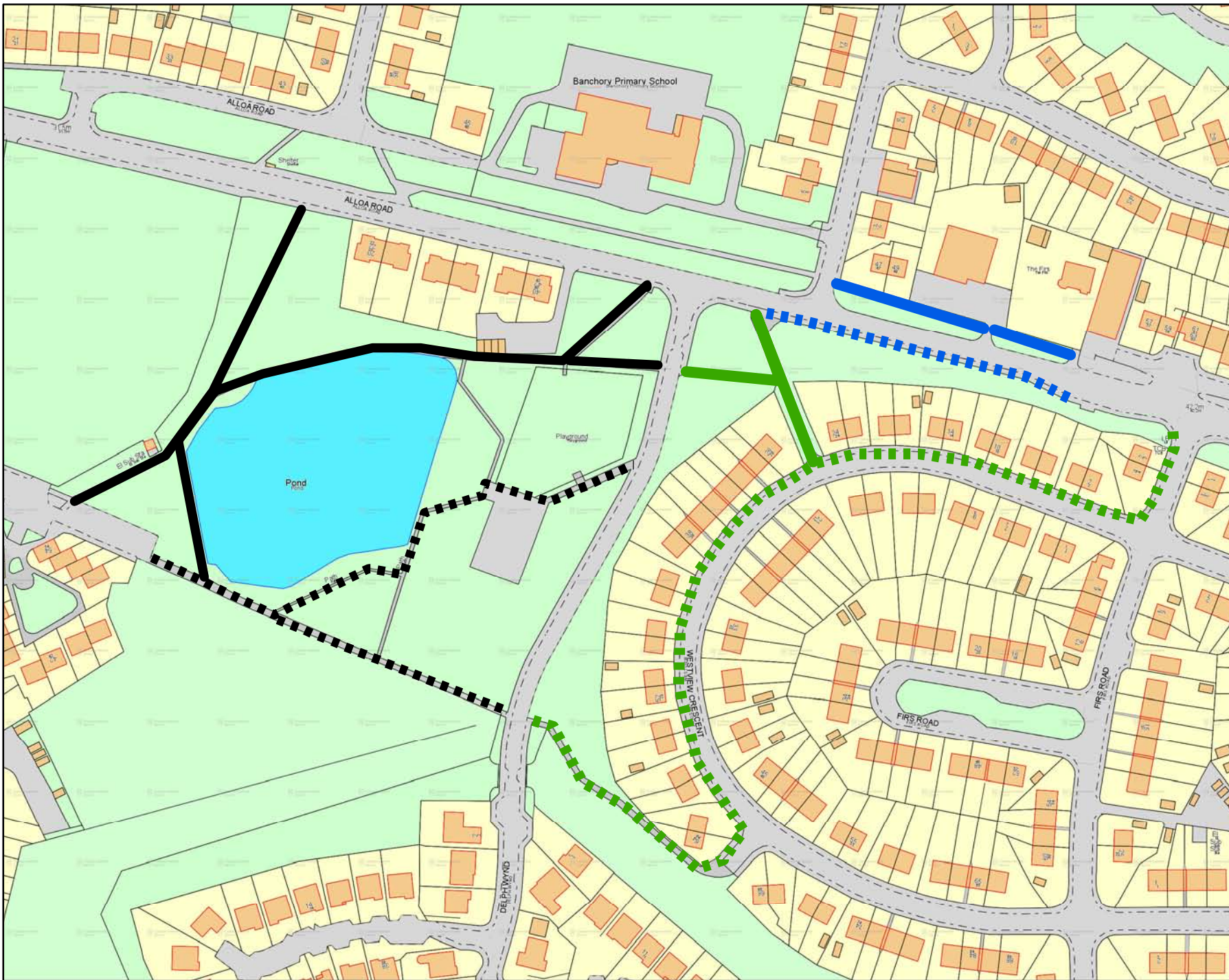

Scale : NTS
Paper Size : A4

Date: February 2016

 **Clackmannanshire Council**
www.clacksweb.org.uk

Services to Communities
Kilncraigs
Greenside Street
Alloa
FK10 1EB

Tel: 01259 450 000 Fax: 01259 727 452
development_services@clacks.gov.uk

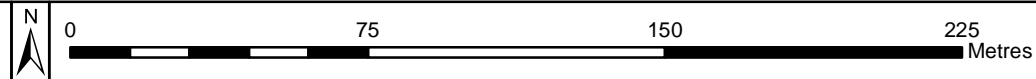

TRO2016_018a
Tullibody

FP - Schedule 4

-  Closure
-  Diversion

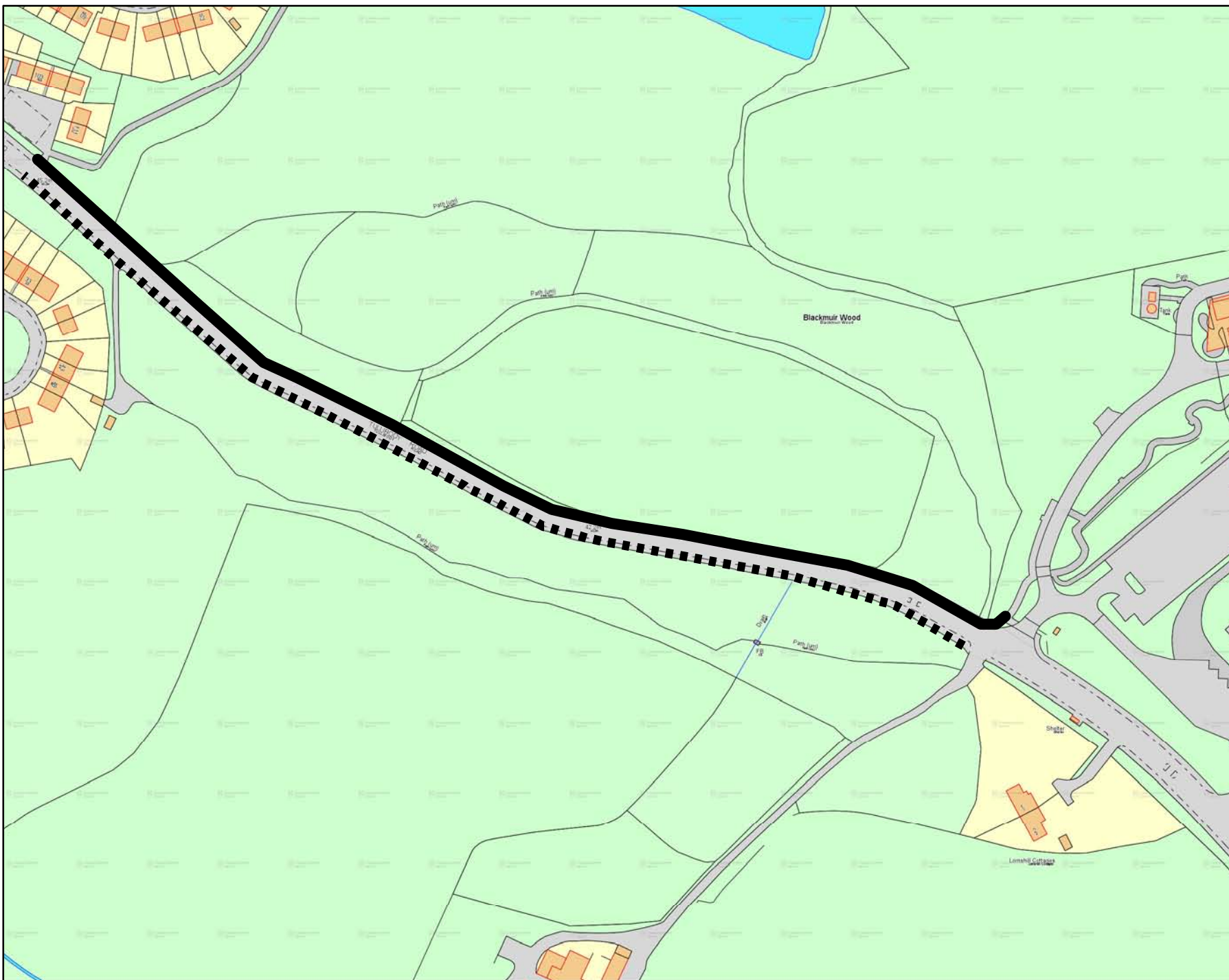

Scale : NTS
Paper Size : A4

Date: February 2016

 **Clackmannanshire Council**
www.clacksweb.org.uk

Services to Communities
Kilncraigs
Greenside Street
Alloa
FK10 1EB

Tel: 01259 450 000 Fax: 01259 727 452
development_services@clacks.gov.uk

Reproduced by permission of Ordnance Survey on behalf of HMSO.
© Crown copyright and database right 2016. All rights reserved.
Ordnance Survey Licence number 100020783.

