



**Clackmannanshire
Council**

www.clacksweb.org.uk

**(VARIOUS STREETS, ALVA (NORTH))
(20 MPH SPEED LIMIT) ORDER 2014**

Clackmannanshire Council, in exercise of the powers conferred upon it by Section 84(1) and (2) and Part IV of Schedule 9 to the Road Traffic Regulation Act 1984 (as amended) and all other enabling powers and after consultation with the Chief Officer of Police in accordance with Part III of Schedule 9 to the said Act, hereby make the following Order:-

- (1) This Order may be cited as "The Clackmannanshire Council (Various Streets, Alva (North)) (20 mph Speed Limit) Order 2014" and shall come into operation on 5 December 2014.
- (2) The Interpretation Act 1978 shall apply for the interpretation of this Order as it applies for the interpretation of an Act of Parliament.
- (3) A speed limit of 20 miles per hour is hereby imposed on the lengths of roads specified in the Schedule to this Order and no person shall drive any motor vehicle at a speed exceeding 20 miles per hour on the said lengths of roads.
- (4) The restriction imposed by this Order shall be in addition to and not in derogation of any restriction or requirement imposed by any regulations made or having effect as if made under the Road Traffic Regulation Act 1984 or by or under any other enactment.

DATED THIS SEVENTEENTH DAY OF NOVEMBER, TWO THOUSAND AND FOURTEEN

Garry Dallas
Executive Director

Clackmannanshire Council
Kilncraigs
ALLOA, FK10 1EB

**THE CLACKMANNANSHIRE COUNCIL
(VARIOUS STREETS, ALVA (NORTH))
(20 MPH SPEED LIMIT) ORDER 2014**

Schedule	
Lengths of Road in Alva	Sections of road over which a 20 mph speed limit will be applicable.
Back Road, Beauclerc Street, Bevan Five, Braehead, Burnside Farm Road, Cochrane Crescent, Cleuch Drive, Copland Place, Croftshaw Road, Dickie's Well, Erskine Street, Glebe Crescent, Glenwhinnel Road, Grodwell Drive, Henderson Place, Keir Hardie Drive, Lestrane Avenue, Lover's Loan, Maclean Crescent, Maxton Crescent, Ochil Road, Ochilview, Park Street, Provost Hunter Avenue, Robertson Street, Rhodders Grove, Silverburn Gardens, Strude Howe, Strude Street, The Brioch, The Cochranes, The Glebe, The Green, The Wynd, Torry Drive, Upper Cobden Street, Upper Queen Street and Wharry Drive.	For their entirety
Brook Street	From its junction with A91 northwards for a distance of 270 metres or thereby.

**THE CLACKMANNANSHIRE COUNCIL
(VARIOUS STREETS, ALVA (NORTH))
(20 MPH SPEED LIMIT) ORDER 2014**

Statement of Reasons for Making the Order

The order is required to ensure that the traffic speeds are limited to a speed compatible with the local environment.

Garry Dallas
Executive Director

Clackmannanshire Council
Kilncraigs
ALLOA
FK10 1EB

**THE CLACKMANNANSHIRE COUNCIL
(VARIOUS STREETS, ALVA (NORTH))
(20 MPH SPEED LIMIT) ORDER 2014**

Clackmannanshire Council has made the above named Order under Section 84(1) and (2) and Part IV of Schedule 9 to the Road Traffic Regulation Act 1984 (as amended) on 17 November 2014.

FULL DETAILS of this Order is as published in the Alloa Advertiser on the 17 September 2014 and will designate the sections of roads described in the Schedule as a 20 miles per hour speed limit to ensure that traffic speeds are limited to a speed compatible with the local environment. A copy of the order, together with a copy of the relative plan is available on www.clacksweb.org.uk or may be examined at Clackmannanshire Council's Offices, Kilncraigs, Alloa, FK10 1EB or at any council office, library or Community Access Point, during normal office hours free of charge.

Any person wishing to object to the validity of the order or of any provision contained therein on the grounds that it is not within the powers conferred by the aforesaid Act or that if any requirement therein has not been complied with, may within six weeks from 5 December 2014 apply to the Court of Session for this purpose.

Garry Dallas
Executive Director

Clackmannanshire Council, Kilncraigs, ALLOA, FK10 1EB

Schedule	
Lengths of Road in Alva	Sections of road over which a 20 mph speed limit will be applicable.
Back Road, Beauclerc Street, Bevan Five, Braehead, Burnside Farm Road, Cochrane Crescent, Cleuch Drive, Copland Place, Croftshaw Road, Dickie's Well, Erskine Street, Glebe Crescent, Glenwhinnel Road, Grodwell Drive, Henderson Place, Keir Hardie Drive, Lestrangle Avenue, Lover's Loan, Maclean Crescent, Maxton Crescent, Ochil Road, Ochilview, Park Street, Provost Hunter Avenue, Robertson Street, Rhodders Grove, Silverburn Gardens, Strude Howe, Strude Street, The Brioch, The Cochranes, The Glebe, The Green, The Wynd, Torry Drive, Upper Cobden Street, Upper Queen Street and Wharry Drive.	For their entirety
Brook Street	From its junction with A91 northwards for a distance of 270 metres or thereby.

**THE CLACKMANNANSHIRE COUNCIL (VARIOUS STREETS, ALVA (NORTH)) (20 MPH SPEED LIMIT)
ORDER 2014**

The Council proposes to make the above Order under Section 84(1) and (2) and Part IV of Schedule 9 to the Road Traffic Regulation Act 1984. This will designate the sections of roads in Alva: Back Road, Beauclerc Street, Bevan Five, Braehead, Burnside Farm Road, Cochrane Crescent, Cleuch Drive, Copland Place, Croftshaw Road, Dickie's Well, Erskine Street, Glebe Crescent, Glenwhinnel Road, Grodwell Drive, Henderson Place, Keir Hardie Drive, Lestrangle Avenue, Lover's Loan, Maclean Crescent, Maxton Crescent, Ochil Road, Ochilview, Park Street, Provost Hunter Avenue, Robertson Street, Rhodders Grove, Silverburn Gardens, Strude Howe, Strude Street, The Brioch, The Cochranes, The Glebe, The Green, The Wynd, Torry Drive, Upper Cobden Street, Upper Queen Street and Wharry Drive for their entirety; Brook Street, Alva (From its junction with A91 northwards for a distance of 270 metres or thereby) as a 20 miles per hour speed limit to ensure that traffic speeds are limited to a speed compatible with the local environment. Objectors must state their reasons in writing to Gillian White, Strategy and Customer Services, Kilncraigs, Alloa, FK10 1EB by 10/10/14. Full details are available on www.clacksweb.org.uk or may be examined at Clackmannanshire Council's Offices, Kilncraigs, Alloa, FK10 1EB, and any Council Office/Library, during normal office hours between 17/09/14 and 10/10/14.

**THE CLACKMANNANSHIRE COUNCIL (VARIOUS STREETS, ALVA (NORTH)) (20 MPH SPEED LIMIT)
ORDER 2014**

The Council has made the above Order under Section 84(1) and (2) and Part IV of Schedule 9 to the Road Traffic Regulation Act 1984. This will designate the sections of roads in Alva: Back Road, Beauclerc Street, Bevan Five, Braehead, Burnside Farm Road, Cochrane Crescent, Cleuch Drive, Copland Place, Croftshaw Road, Dickie's Well, Erskine Street, Glebe Crescent, Glenwhinnel Road, Grodwell Drive, Henderson Place, Keir Hardie Drive, Lestrangle Avenue, Lover's Loan, Maclean Crescent, Maxton Crescent, Ochil Road, Ochilview, Park Street, Provost Hunter Avenue, Robertson Street, Rhodders Grove, Silverburn Gardens, Strude Howe, Strude Street, The Brioch, The Cochranes, The Glebe, The Green, The Wynd, Torry Drive, Upper Cobden Street, Upper Queen Street and Wharry Drive for their entirety; Brook Street, Alva (From its junction with A91 northwards for a distance of 270 metres or thereby) as a 20 miles per hour speed limit to ensure that traffic speeds are limited to a speed compatible with the local environment. Anyone wishing to question the validity of any of the provisions within this order should write to the Court of session within six weeks of 5 December 2014. Full details are available on www.clacksweb.org.uk or may be examined at Clackmannanshire Council's Offices, Kilncraigs, Alloa, FK10 1EB, and any Council Office/Library, during normal office hours.

**THE CLACKMANNANSHIRE COUNCIL
(VARIOUS STREETS, ALVA (NORTH))
(20 MPH SPEED LIMIT) ORDER 2014**

This is the plan referred to in The Clackmannanshire Council (Various Streets, Alva (North)) (20 mph Speed Limit) Order 2014 made by Clackmannanshire Council on 17 December 2014.

Garry Dallas
Executive Director

Clackmannanshire Council
Kilncraigs
ALLOA
FK10 1EB

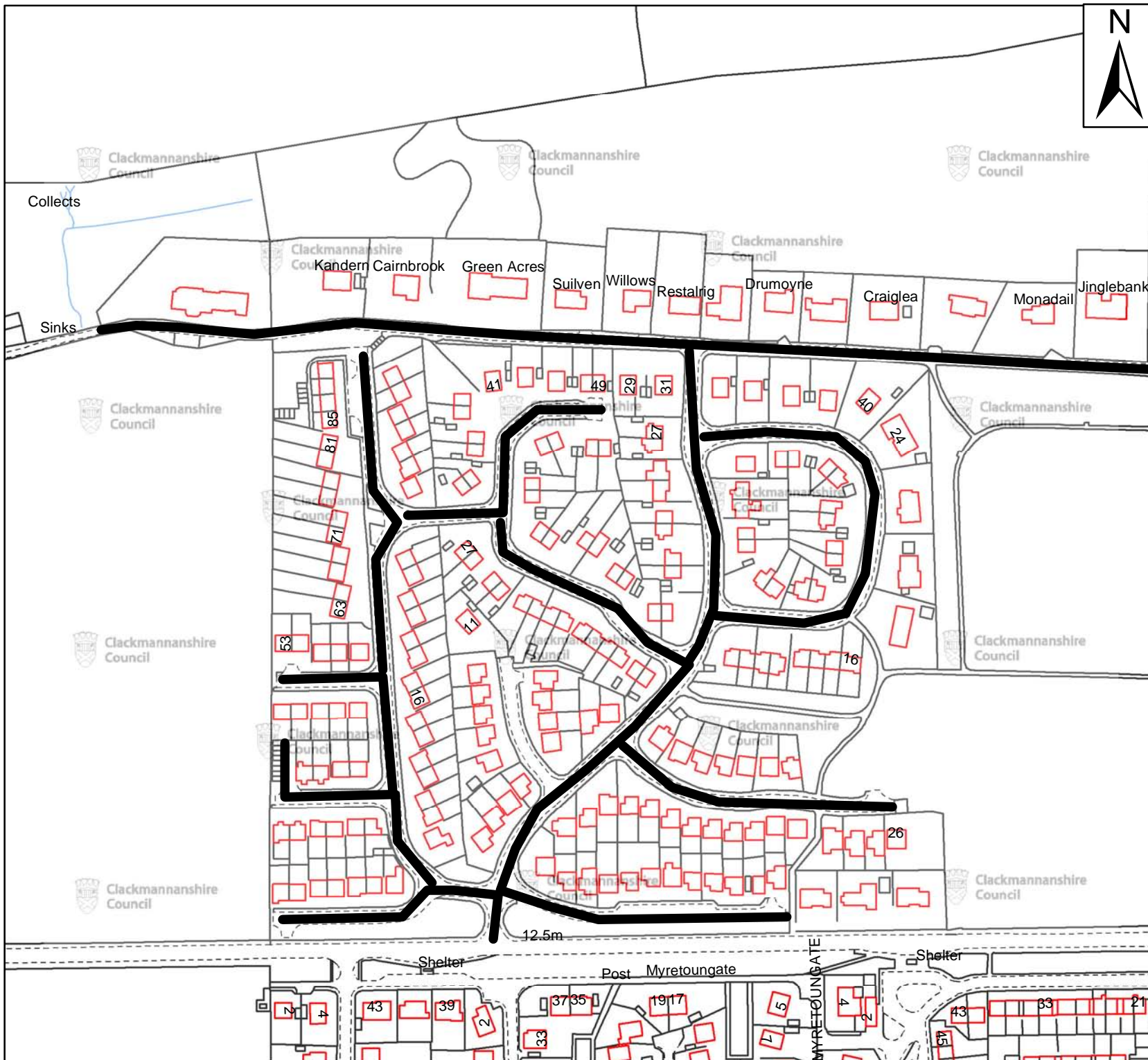

 20mph speed limit

DRG14-031

20mph Speed Limit - Alva (North)
Page 1

Scale : NTS
Paper Size : A4

Date : August 2014



**Clackmannanshire
Council**



www.clacksweb.org.uk

Services to Communities
Kilncraigs
Greenside Street
Alloa
FK10 1EB

Tel: 01259 450 000 Fax: 01259 727 452
development_services@clacks.gov.uk

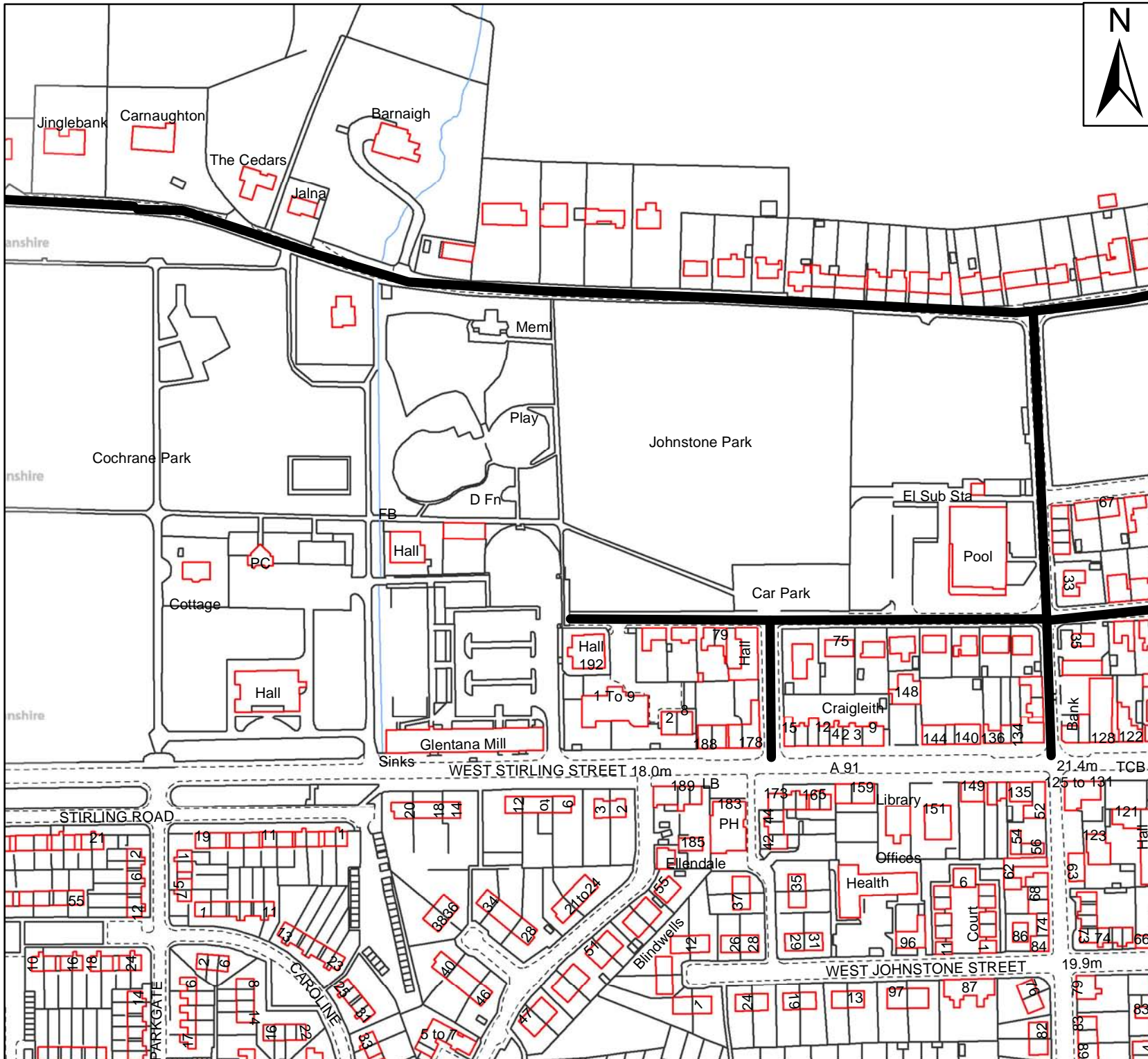
Reproduced by permission of Ordnance Survey
on behalf of HMSO. © Crown copyright and
database right 2014. All rights reserved.
Ordnance Survey Licence number 100020783.





20mph speed limit

DRG14-031_1

20mph Speed Limit - Alva (North)
Page 2

Scale : NTS
Paper Size : A4

Date : August 2014

**Clackmannanshire Council**
www.clacksweb.org.uk
Services to Communities
Kilncraigs
Greenside Street
Alloa
FK10 1EB

Tel: 01259 450 000 Fax: 01259 727 452
development_services@clacks.gov.uk

Reproduced by permission of Ordnance Survey on behalf of HMSO. © Crown copyright and database right 2014. All rights reserved.
Ordnance Survey Licence number 100020783.

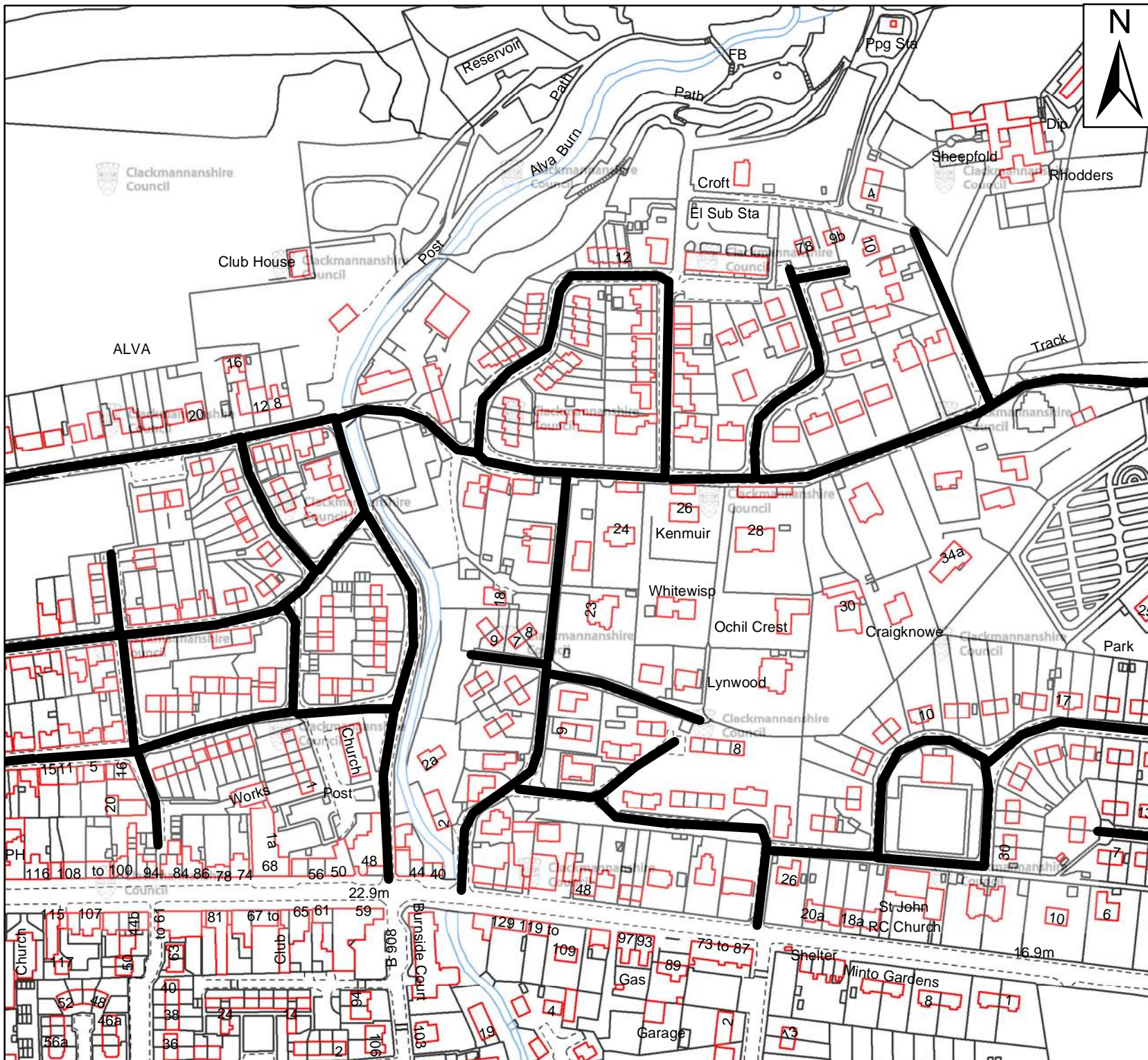

20mph speed limit

DRG14-031_2

20mph Speed Limit - Alva (North)
Page 3

Scale : NTS
Paper Size : A4

Date : August 2014

 **Clackmannanshire Council**
www.clacksweb.org.uk
Services to Communities
Kilncraigs
Greenside Street
Alloa
FK10 1EB

Tel: 01259 450 000 Fax: 01259 727 452
development_services@clacks.gov.uk

Reproduced by permission of Ordnance Survey on behalf of HMSO. © Crown copyright and database right 2014. All rights reserved.
Ordnance Survey Licence number 100020783.

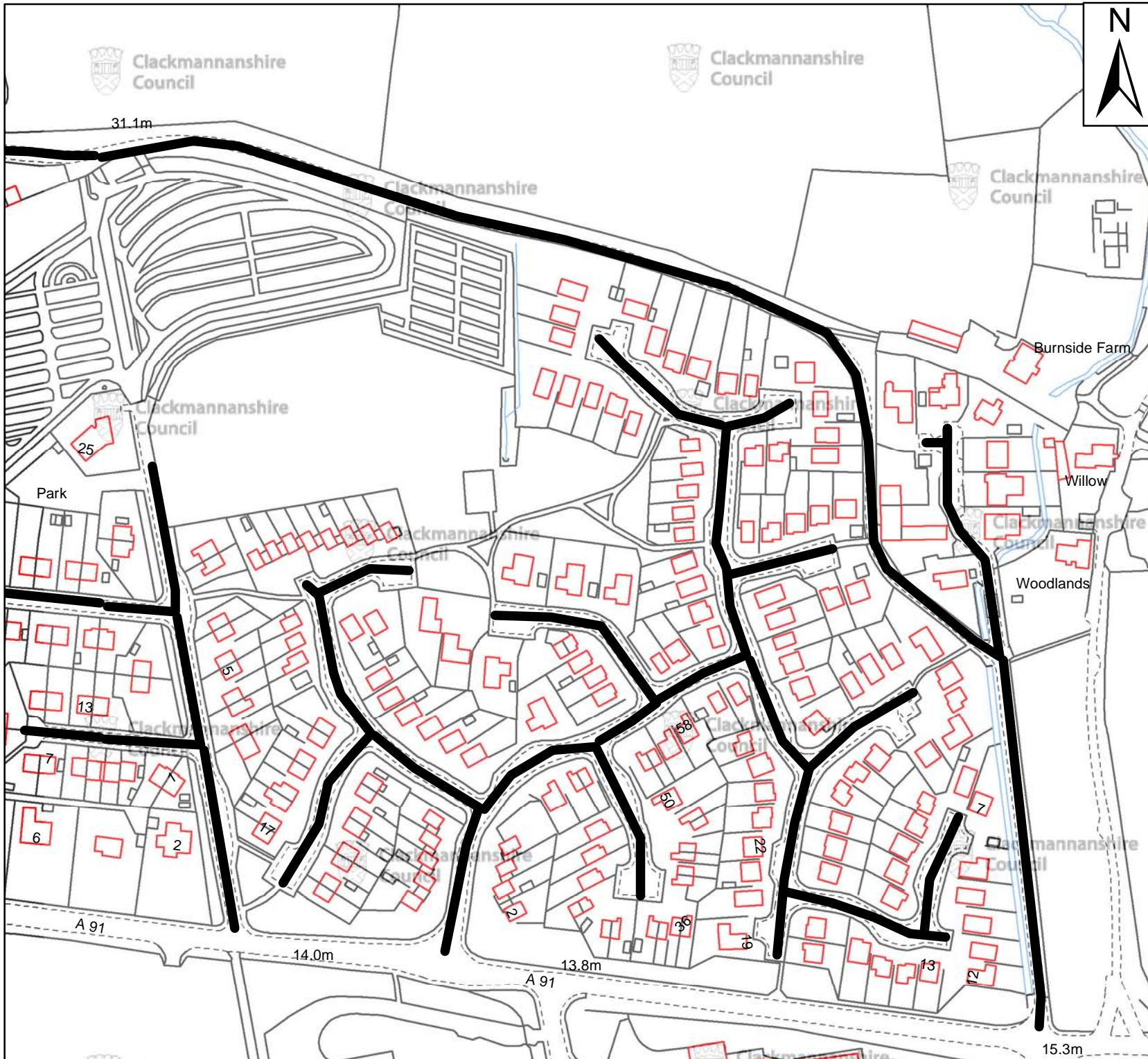



20mph speed limit

DRG14-031_3

20mph Speed Limit - Alva (North)
Page 4

Scale : NTS
Paper Size : A4

Date : August 2014



Clackmannanshire Council
www.clacksweb.org.uk
Services to Communities
Kilncraigs
Greenside Street
Alloa
FK10 1EB

Tel: 01259 450 000 Fax: 01259 727 452
development_services@clacks.gov.uk

Reproduced by permission of Ordnance Survey on behalf of HMSO. © Crown copyright and database right 2014. All rights reserved.
Ordnance Survey Licence number 100020783.