



**(VARIOUS STREETS, CLACKMANNANSHIRE)
(TEMPORARY CLOSURE) ORDER 2014**

The Clackmannanshire Council, in exercise of the powers conferred on them by Section 14 of the Road Traffic Regulation Act 1984 as amended by the Road Traffic (Temporary Restrictions) Act 1991 and of all other powers enabling them in that behalf, hereby make the following Order.

1. This Order may be cited as "The Clackmannanshire Council (Various Streets, Clackmannanshire) (Temporary Closure) Order 2014" and notwithstanding the date hereof shall come into operation on the 25th June 2014.

2. The effect of this Order shall be to close to vehicles:-

The period from 1000 hours until 1030 hours on Wednesday 25th June 2014 on the section described in Schedule 1 attached; the period from 1000 hours until 1115 hours on Wednesday 25th June 2014 in Schedule 2 attached; the period from 0930 hours until 1300 hours on Wednesday 25th June 2014 in Schedule 3 attached; the period from 1230 hours until 1330 hours on Wednesday 25th June 2014 on the section described in Schedule 4 attached; the period from 1500 hours until 1600 hours on Wednesday 25th June 2014 in Schedule 5 attached; the period from 1615 hours until 1630 hours and, 1715 hours until 1730 hours on Wednesday 25th June 2014 in Schedule 6 attached; and the period from 1630 hours until 1815 hours on Wednesday 25th June 2014 in Schedule 7 attached. The temporary closure is necessary to facilitate the Commonwealth Games Baton Relay.

DATED THIS SIXTH OF JUNE, TWO THOUSAND AND FOURTEEN

Garry Dallas
Director of Services to Communities

Clackmannanshire Council, Greenfield, ALLOA, FK10 2AD

SCHEDULE 1	
List of Road	Sections of road over which temporary road closure is applicable from 1000 hours until 1030 hours on Wednesday 25th June 2014.
Lime Tree Walk, Alloa	From its junction with Broad Street southwards to its junction with Bowhouse Road, a distance of 258 metres or thereby.
Bowhouse Road, Alloa	From its junction with Lime Tree Walk eastwards to its junction with Younger Street, a distance of 158 metres or thereby.

Alternative Route	Via Broad Street, Greenfield Street, Auld Brig Road, Clackmannan Road, Alloa Park Drive, Forth Crescent, Bristol Street, Bowhouse Road and vice versa.
SCHEDULE 2	
List of Roads	Sections of road over which temporary road closure is applicable from 1000 hours until 1115 hours on Wednesday 25th June 2014.
Kilncraigs Car Park	For its entirety.
SCHEDULE 3	
List of Roads	Sections of road over which temporary road closure is applicable from 0930 hours until 1300 hours on Wednesday 25th June 2014.
Mar Place, Sauchie	From its junction with Parkhead Road northwards to its junction with Holton Crescent, a distance of 167 metres or thereby.
Main Street (Unclassified)	From its junction with Holton Crescent northwards to its junction with A908 Main Street, a distance of 144 metres or thereby.
Alternative Route	Via Parkhead Road, A908 Main Street and vice versa.
SCHEDULE 4	
List of Roads	Sections of road over which temporary road closure is applicable from 1230 hours until 1330 hours on Wednesday 25th June 2014.
Dollar Glen Car Park	For its entirety.
SCHEDULE 5	
List of Roads	Sections of road over which temporary road closure is applicable from 1500 hours until 1600 hours on Wednesday 25th June 2014.
Ramsay Terrace, Tillicoultry	For its entirety a distance of 130 metres or thereby.
Roundelwood, Tillicoultry	For its entirety, a distance of 92 metres or thereby.
Alternative Route	Via Stalker Avenue, North Hill Street and vice versa.
SCHEDULE 6	
List of Roads	Sections of road over which temporary road closure is applicable from 1615 hours until 1630 hours, and 1715 hours until 1730 hours on Wednesday 25th June 2014.
Cochrane Park Entrance	For its entirety.
SCHEDULE 7	
List of Roads	Sections of road over which temporary road closure is applicable from 1630 hours until 1815 hours on Wednesday 25th June 2014.
Castle Road, Menstrie	For its entirety, a distance of 46 metres or thereby.
Menstrie Place, Menstrie	For its entirety, a distance of 140 metres or thereby.
Elmbank, Menstrie	From its junction with Menstrie Place eastwards to its junction with Forthvale, a distance of 215 metres or thereby.
Alternative Route	Via Brook Street, A91, Forthvale and vice versa.

THE CLACKMANNANSHIRE COUNCIL
(VARIOUS STREETS, CLACKMANNANSHIRE)
(TEMPORARY CLOSURE) ORDER 2014

STATEMENT OF REASONS FOR MAKING THE ORDER

The order is required is necessary to facilitate the Commonwealth Games Baton Relay.

Garry Dallas
Director of Services to Communities

Clackmannanshire Council
Greenfield
ALLOA
FK10 2AD

The Clackmannanshire Council (Various Streets, Clackmannanshire) (Temporary Closure) Order 2014

The Council has made "The Clackmannanshire Council (Various Streets, Clackmannanshire) (Temporary Closure) Order 2014", under the Road Traffic Regulation Act 1984 (as amended) on 6th June 2014: to close to vehicles at **(SCHEDULE 1): Lime Tree Walk, Alloa** from its junction with Broad Street southwards to its junction with Bowhouse Road, a distance of 258 metres or thereby; **Bowhouse Road, Alloa** from its junction with Lime Tree Walk eastwards to its junction with Younger Street, a distance of 158 metres or thereby. (Alternative Route: Via Broad Street, Greenfield Street, Auld Brig Road, Clackmannan Road, Alloa Park Drive, Forth Crescent, Bristol Street, Bowhouse Road and vice versa). Schedule 1 runs from the period from 1000 hours until 1030 hours on Wednesday 25th June 2014. **(SCHEDULE 2): Kilncraigs Car Park** for its entirety. Schedule 2 runs from the period from 1000 hours until 1115 hours on Wednesday 25th June 2014. **(SCHEDULE 3): Mar Place, Sauchie** from its junction with Parkhead Road northwards to its junction with Holton Crescent, a distance of 167 metres or thereby; **Main Street (Unclassified)** from its junction with Holton Crescent northwards to its junction with A908 Main Street, a distance of 144 metres or thereby. (Alternative Route: Via Parkhead Road, A908 Main Street and vice versa). Schedule 3 runs from the period from 0930 hours until 1300 hours on Wednesday 25th June 2014. **(SCHEDULE 4): Dollar Glen Car Park** for its entirety. Schedule 4 runs from the period from 1230 hours until 1330 hours on Wednesday 25th June 2014. **(SCHEDULE 5): Ramsay Terrace, Tillicoultry** for its entirety, a distance of 130 metres or thereby; **Roundelwood, Tillicoultry** for its entirety, a distance of 92 metres or thereby. (Alternative Route: Via Stalker Avenue, North Hill Street and vice versa). Schedule 5 runs from the period from 1500 hours until 1600 hours on Wednesday 25th June 2014. **(SCHEDULE 6): Cochrane Park Entrance** for its entirety. Schedule 6 runs from the period from 1615 hours until 1630 hours, and 1715 hours until 1730 hours on Wednesday 25th June 2014. **(SCHEDULE 7): Castle Road, Menstrie** for its entirety, a distance of 46 metres or thereby; **Menstrie Place, Menstrie** for its entirety, a distance of 140 metres or thereby; **Elmbank, Menstrie** from its junction with Menstrie Place eastwards to its junction with Forthvale, a distance of 215 metres or thereby. (Alternative Route: Via Brook Street, Forthvale and vice versa). Schedule 7 runs from the period from 1630 hours until 1815 hours on Wednesday 25th June 2014. The Temporary Closures are necessary to facilitate the Commonwealth Games Baton Relay. Full details are available on www.clacksweb.org.uk or may be examined at Clackmannanshire Council's Offices, Greenfield, Alloa, FK10 2AD, and any Council Office/Library, during normal office hours.

THE CLACKMANNANSHIRE COUNCIL
(VARIOUS STREETS, CLACKMANNANSHIRE)
(TEMPORARY CLOSURE) ORDER 2014

The Clackmannanshire Council has made the above named Order under Section 14 of the Road Traffic Regulation Act 1984 (as amended) on 6th June 2014.

The effect of this Order shall be to close to vehicles:-

The period from 1000 hours until 1030 hours on Wednesday 25th June 2014 on the section described in Schedule 1 attached; the period from 1000 hours until 1115 hours on Wednesday 25th June 2014 in Schedule 2 attached; the period from 0930 hours until 1300 hours on Wednesday 25th June 2014 in Schedule 3 attached; the period from 1230 hours until 1330 hours on Wednesday 25th June 2014 on the section described in Schedule 4 attached; the period from 1500 hours until 1600 hours on Wednesday 25th June 2014 in Schedule 5 attached; the period from 1615 hours until 1630, and 1715 until 1730 hours on Wednesday 25th June 2014 in Schedule 6 attached; the period from 1630 hours until 1815 hours on Wednesday 25th June 2014 in Schedule 7 attached. The temporary closure is necessary to facilitate the Commonwealth Games Baton Relay.

A copy of the Order, together with a copy of the relative plan, is available on www.clacksweb.org.uk or may be examined at Clackmannanshire Council's Offices, Greenfield, Alloa, FK10 2AD, and any Council Office/Library, during normal office hours free of charge.

Garry Dallas
Director of Services to Communities

Clackmannanshire Council
Greenfield
ALLOA
FK10 2AD

SCHEDULE 1	
List of Road	Sections of road over which temporary road closure is applicable from 1000 hours until 1030 hours on Wednesday 25th June 2014.
Lime Tree Walk, Alloa	From its junction with Broad Street southwards to its junction with Bowhouse Road, a distance of 258 metres or thereby.
Bowhouse Road, Alloa	From its junction with Lime Tree Walk eastwards to its junction with Younger Street, a distance of 158 metres or thereby.
Alternative Route	Via Broad Street, Greenfield Street, Auld Brig Road, Clackmannan Road, Alloa Park Drive, Forth Crescent, Bristol Street, Bowhouse Road and vice versa.

SCHEDULE 2	
List of Roads	Sections of road over which temporary road closure is applicable from 1000 hours until 1115 hours on Wednesday 25th June 2014.
Kilncraigs Car Park	For its entirety.
SCHEDULE 3	
List of Roads	Sections of road over which temporary road closure is applicable from 0930 hours until 1300 hours on Wednesday 25th June 2014.
Mar Place, Sauchie	From its junction with Parkhead Road northwards to its junction with Holton Crescent, a distance of 167 metres or thereby.
Main Street (Unclassified)	From its junction with Holton Crescent northwards to its junction with A908 Main Street, a distance of 144 metres or thereby.
Alternative Route	Via Parkhead Road, A908 Main Street and vice versa.
SCHEDULE 4	
List of Roads	Sections of road over which temporary road closure is applicable from 1230 hours until 1330 hours on Wednesday 25th June 2014.
Dollar Glen Car Park	For its entirety.
SCHEDULE 5	
List of Roads	Sections of road over which temporary road closure is applicable from 1500 hours until 1600 hours on Wednesday 25th June 2014.
Ramsay Terrace, Tillicoultry	For its entirety a distance of 130 metres or thereby.
Roundelwood, Tillicoultry	For its entirety, a distance of 92 metres or thereby.
Alternative Route	Via Stalker Avenue, North Hill Street and vice versa.
SCHEDULE 6	
List of Roads	Sections of road over which temporary road closure is applicable from 1615 hours until 1630 hours, and 1715 hours until 1730 hours on Wednesday 25th June 2014.
Cochrane Park Entrance	For its entirety.
SCHEDULE 7	
List of Roads	Sections of road over which temporary road closure is applicable from 1630 hours until 1815 hours on Wednesday 25th June 2014.
Castle Road, Menstrie	For its entirety, a distance of 46 metres or thereby.
Menstrie Place, Menstrie	For its entirety, a distance of 140 metres or thereby.
Elmbank, Menstrie	From its junction with Menstrie Place eastwards to its junction with Forthvale, a distance of 215 metres or thereby.
Alternative Route	Via Brook Street, A91, Forthvale and vice versa.

THE CLACKMANNANSHIRE COUNCIL
(VARIOUS STREETS, CLACKMANNANSHIRE)
(TEMPORARY CLOSURE) ORDER 2014

This is the plan referred to in the Clackmannanshire Council (Various Streets, Clackmannanshire) (Temporary Closure) Order 2014.

Made by Clackmannanshire Council on 6th June 2014.

Garry Dallas
Director of Services to Communities

Clackmannanshire Council
Greenfield
ALLOA
FK10 2AD

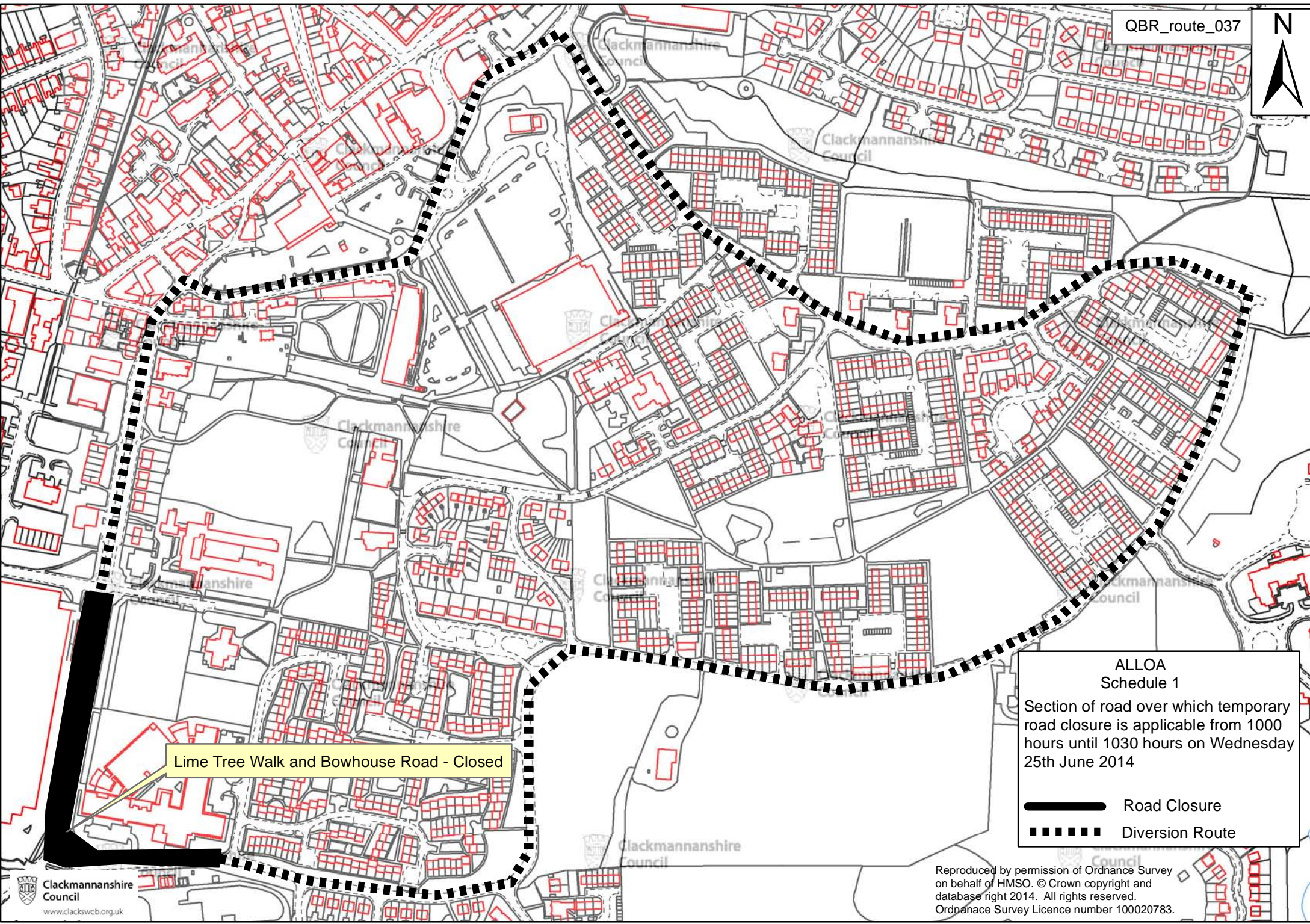

Lime Tree Walk and Bowhouse Road - Closed

ALLOA
Schedule 1
Section of road over which temporary
road closure is applicable from 1000
hours until 1030 hours on Wednesday
25th June 2014

———— Road Closure
- - - - - Diversion Route



El Sub Sta

Clackmannanshire Council

Clackmannanshire Council

Clackmannanshire Council

Elim Pentecostal Church

Clackmannanshire Council

Clackmannanshire Council

Clackmannanshire Council

Clackmannanshire Council

Clackmannanshire Council

Clackmannanshire Council

Cemetery

Clackmannanshire Council



Clackmannanshire Council

Clackmannanshire Council

Clackmannanshire Council

El Sub Sta

KILNCRAIGS CAR PARK
 Schedule 2
 Section of road over which temporary road closure is applicable from 1000 hours until 1115 hours on Wednesday 25th June 2014



 Road Closure
 Diversion Route



Mapr Place and Main Street (unclas)

SAUCHIE
Schedule 3

Section of road over which temporary road closure is applicable from 0930 hours until 1300 hours on Wednesday 25th June 2014

-  Road Closure
-  Diversion Route

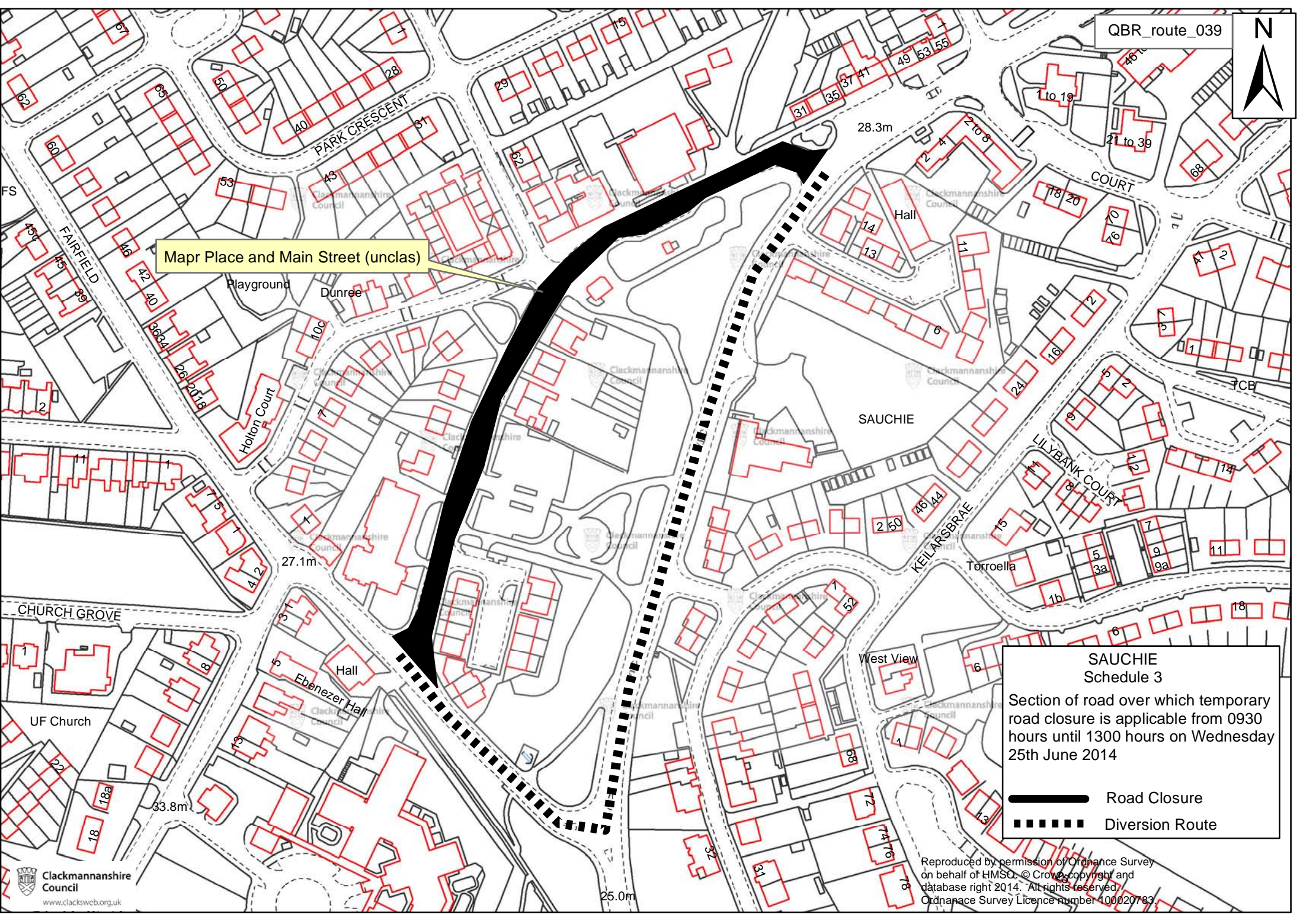

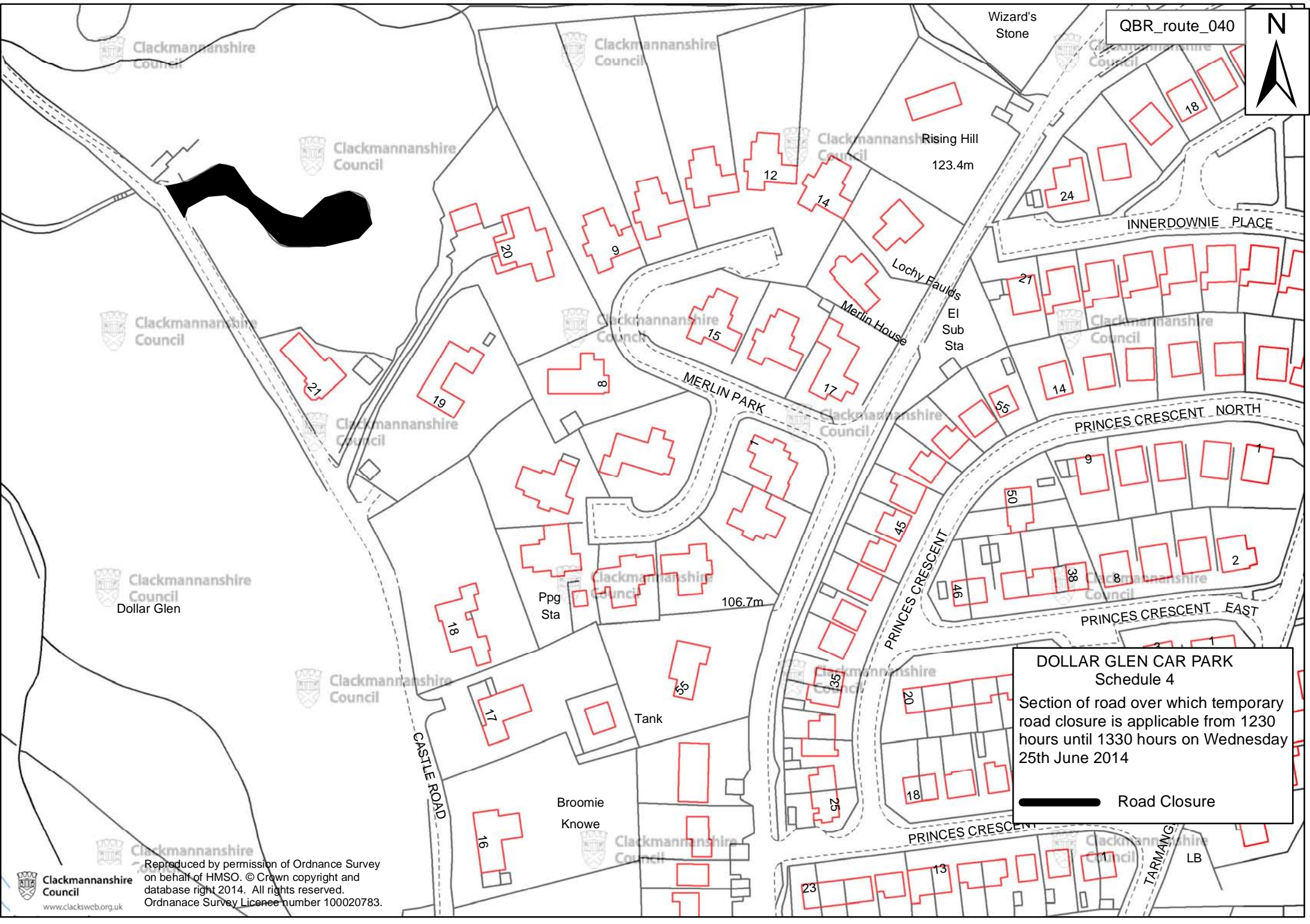

DOLLAR GLEN CAR PARK
 Schedule 4
 Section of road over which temporary
 road closure is applicable from 1230
 hours until 1330 hours on Wednesday
 25th June 2014

 Road Closure





Ramsay Terrace and Roundelwood

FB
EI Sub Sta

TILlicouLTRY
Schedule 5

Section of road over which temporary road closure is applicable from 1500 hours until 1600 hours on Wednesday 25th June 2014

 Road Closure

 Diversion Route

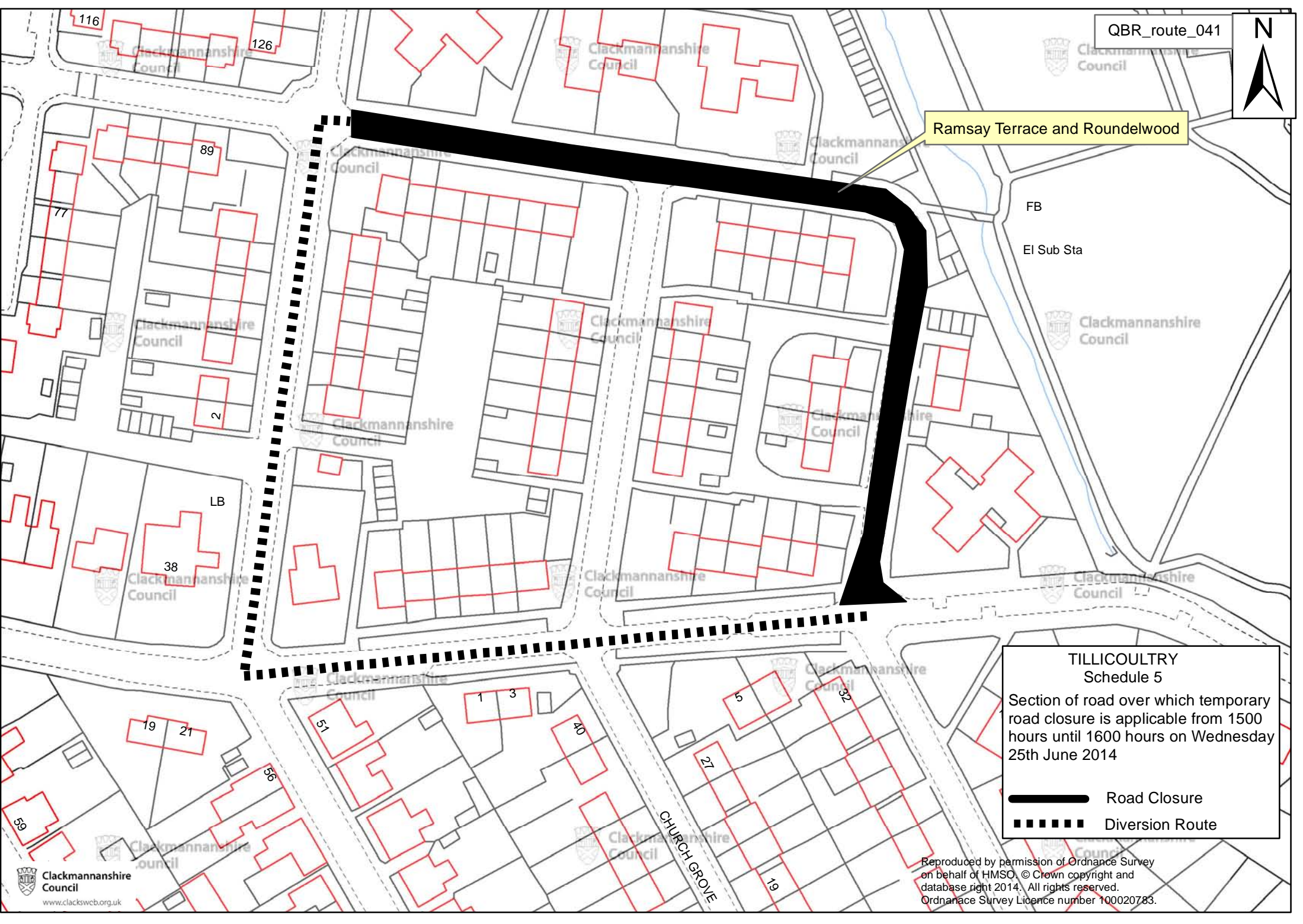



Cochrane Park

D Fn

FB

Hall

Cochrane Park Car Park Access

Cochrane Park Cottage

Hall

192

Glentana Mill

12.9m

14.6m

STIRLING ROAD

ALVA
Schedule 6
Section of road over which temporary road closure is applicable from 1615 hours until 1630 and 1715 hours until 1730 hours on Wednesday 25th June 2014

 Road Closure

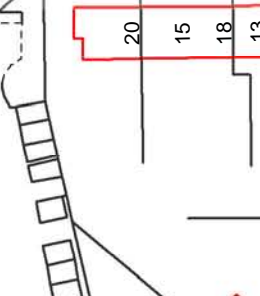
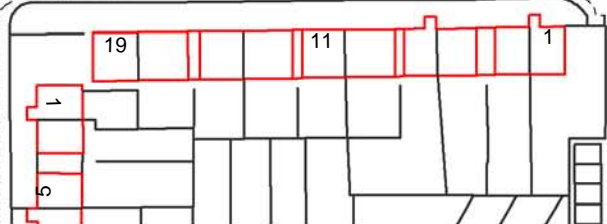
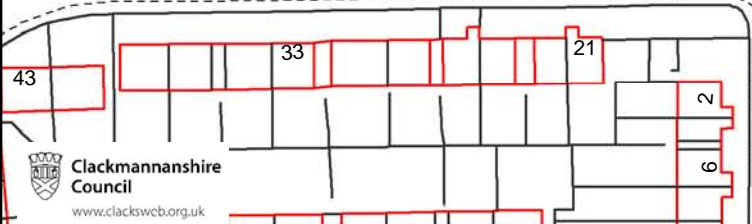

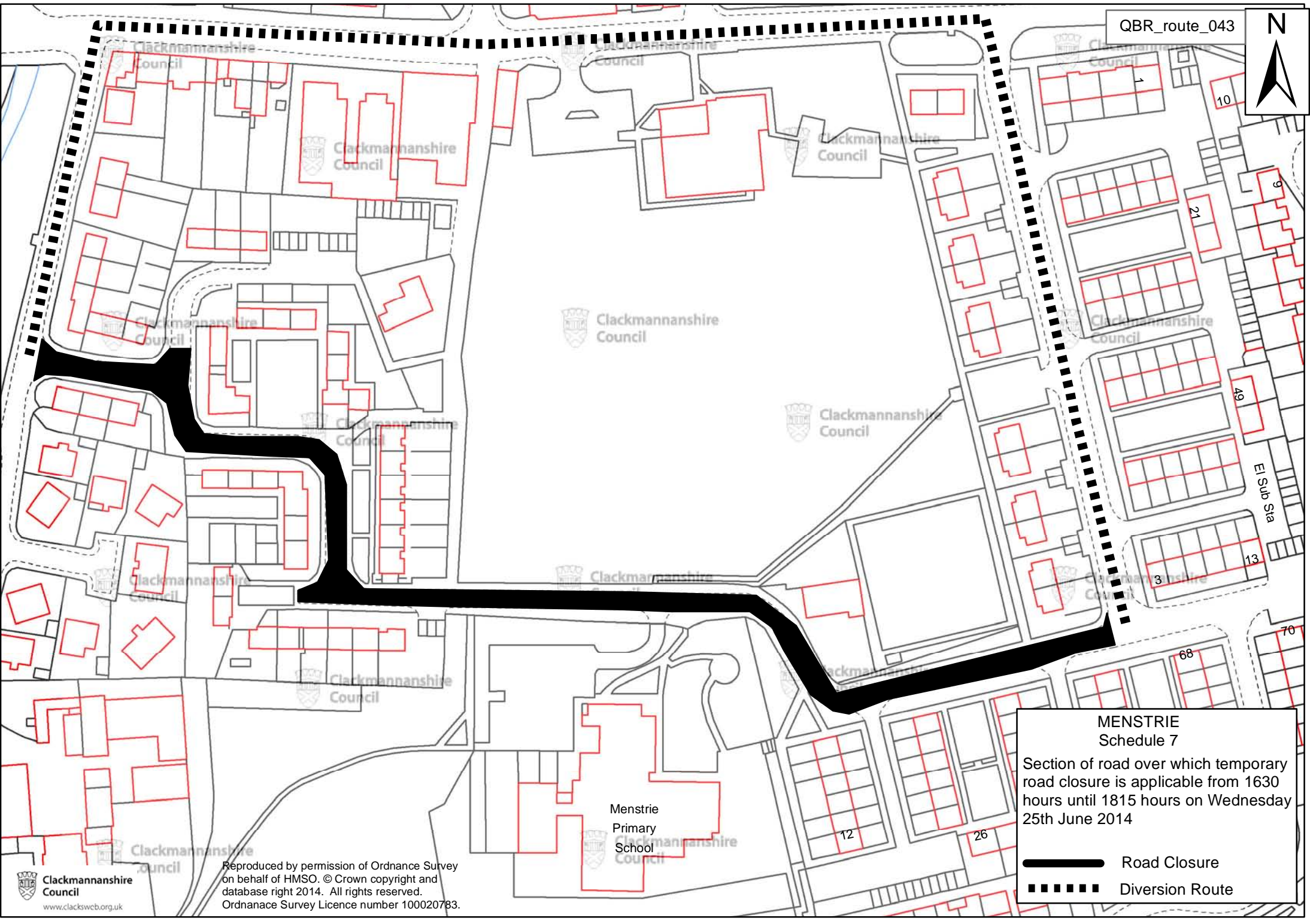

**MENSTRIE
Schedule 7**

Section of road over which temporary road closure is applicable from 1630 hours until 1815 hours on Wednesday 25th June 2014

-  Road Closure
-  Diversion Route

Reproduced by permission of Ordnance Survey on behalf of HMSO. © Crown copyright and database right 2014. All rights reserved. Ordnance Survey Licence number 100020783.