



**(ALLOA PARK DRIVE, ALLOA)
(TEMPORARY CLOSURE) ORDER 2013**

The Clackmannanshire Council, in exercise of the powers conferred on them by Section 14 of the Road Traffic Regulation Act 1984 as amended by the Road Traffic (Temporary Restrictions) Act 1991 and of all other powers enabling them in that behalf, hereby make the following Order.

1. This Order may be cited as "The Clackmannanshire Council (Alloa Park Drive, Alloa) (Temporary Closure) Order 2013" and notwithstanding the date hereof shall come into operation on the 29th July 2013.
2. The effect of this Order shall be to close to vehicles:-
The period from 1900 hours until 0700 each day from Monday, 29th July 2013 until Saturday, 2nd August 2013 on the section described in the Schedule attached. The temporary closure is required due to roadworks on A907.

DATED THIS FOURTH DAY OF JULY, TWO THOUSAND AND THIRTEEN

Garry Dallas
Director of Services to Communities

Clackmannanshire Council, Greenfield, ALLOA, FK10 2AD

SCHEDULE	
List of Road	Section of road over which temporary road closure is applicable from 1900 hours until 0700 hours each day from Monday 29th July 2013 until Saturday 2nd August 2013.
Alloa Park Drive, Alloa	From its junction with Clackmannan Road Roundabout southwards until the next roundabout, a distance of 155 metres or thereby.
Diversion	Via Alloa Park Drive, Forth Crescent, Devon Road, Clackmannan Road and vice versa.

THE CLACKMANNANSHIRE COUNCIL
(ALLOA PARK DRIVE, ALLOA)
(TEMPORARY CLOSURE) ORDER 2013

STATEMENT OF REASONS FOR MAKING THE ORDER

The order is required due to roadworks on A907.

Garry Dallas
Director of Services to Communities

Clackmannanshire Council
Greenfield
ALLOA
FK10 2AD

The Clackmannanshire Council (Alloa Park Drive, Alloa) (Temporary Closure) Order 2013

The Council has made "The Clackmannanshire Council (Alloa Park Drive, Alloa) (Temporary Closure) Order 2013", under the Road Traffic Regulation Act 1984 (as amended) on 4th July 2013: to close to vehicles at Alloa Park Drive, Alloa from its junction with Clackmannan Road Roundabout southwards until the next roundabout, a distance of 155 metres or thereby. (Diversion: Via Alloa Park Drive, Forth Crescent, Devon Road, Clackmannan Road and vice versa). The order runs from 1900 hours until 0700 hours each day from Monday 29th July 2013 until Saturday 2nd August 2013 and is required due to roadworks on A907. Full details are available on www.clacksweb.org.uk or may be examined at Clackmannanshire Council's Offices, Greenfield, Alloa, FK10 2AD, and any Council Office/Library, during normal office hours.

THE CLACKMANNANSHIRE COUNCIL
(ALLOA PARK DRIVE, ALLOA)
(TEMPORARY CLOSURE) ORDER 2013

The Clackmannanshire Council has made the above named Order under Section 14 of the Road Traffic Regulation Act 1984 (as amended) on 4th July 2013.

The effect of this Order shall be to close to vehicles:-

The period from 1900 hours until 0700 hours each day from Monday 29th July 2013 until Saturday 2nd August 2013 on the section described in the Schedule attached. The temporary closure is required due to roadworks on A907.

A copy of the Order, together with a copy of the relative plan, is available on www.clacksweb.org.uk or may be examined at Clackmannanshire Council's Offices, Greenfield, Alloa, FK10 2AD, and any Council Office/Library, during normal office hours free of charge.

Garry Dallas
Director of Services to Communities

Clackmannanshire Council
Greenfield
ALLOA
FK10 2AD

SCHEDULE	
List of Road	Section of road over which temporary road closure is applicable from 1900 hours until 0700 hours each day from Monday 29th July 2013 until Saturday 2nd August 2013.
Alloa Park Drive, Alloa	From its junction with Clackmannan Road Roundabout southwards until the next roundabout, a distance of 155 metres or thereby.
Diversion	Via Alloa Park Drive, Forth Crescent, Devon Road, Clackmannan Road and vice versa.

THE CLACKMANNANSHIRE COUNCIL
(ALLOA PARK DRIVE, ALLOA)
(TEMPORARY CLOSURE) ORDER 2013

This is the plan referred to in the Clackmannanshire Council (Alloa Park Drive, Alloa) (Temporary Closure) Order 2013.

Made by Clackmannanshire Council on 4th July 2013.

Garry Dallas
Director of Services to Communities

Clackmannanshire Council
Greenfield
ALLOA
FK10 2AD

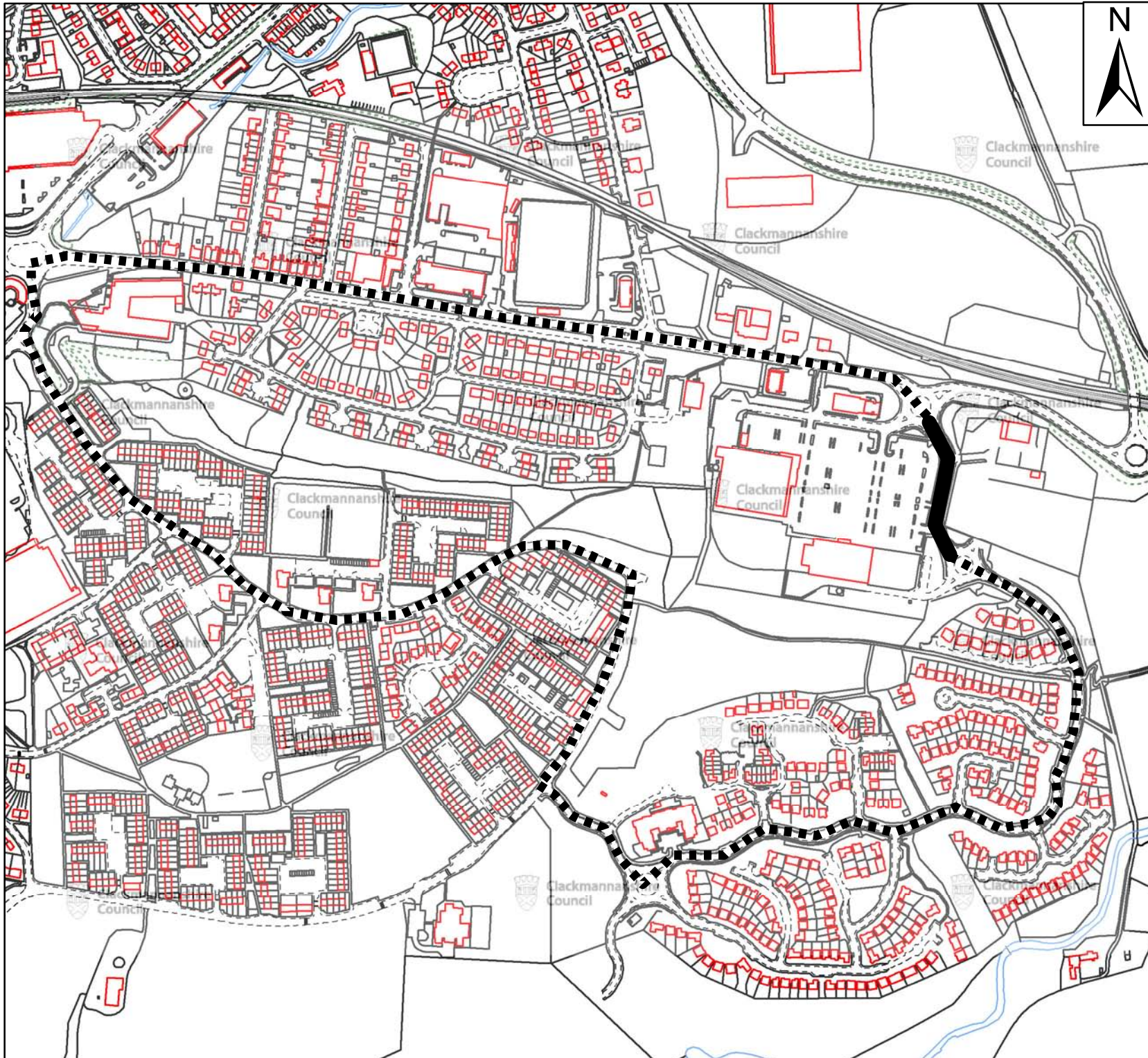

Road Closure
7pm-7am



Diversion

DRG13-082
Alloa Park Drive, Alloa

Scale : NTS
Paper Size : A4

Date : June 2013

 **Clackmannanshire Council**
www.clacksweb.org.uk
Services to Communities
Kilncraigs
Greenside Street
Alloa
FK10 1EB

Tel: 01259 450 000 Fax: 01259 727 452
development_services@clacks.gov.uk

Reproduced by permission of Ordnance Survey on behalf of HMSO. © Crown copyright and database right 2013. All rights reserved.
Ordnance Survey Licence number 100020783.